

COFFEY MACHINERY



2024 | SALES, SERVICE, INSTALLATIONS,
AND TRAINING SOLUTIONS



Financing With Lease Financial, Inc.

Lease Financial, Inc. is a full-service equipment finance company dedicated to serving the manufacturing industry. Our competitive rates, quick turn-around times, and knowledge of the industry and its issues allow us to better serve our customers and business partners.

Customer Benefits

- 100% Financing Available
- Fast Turn-Arounds
- Competitive Rates
- No Deposit Accounts Required
- Can Finance A Multitude Of Equipment
- Specific Filings On Just The Equipment
- No Blanket Filings

Available Options

- Equipment Finance Agreement
- Equipment Lease Agreement
- Fair Market Value/Operating Leases
- 90-Day Deferred Programs
- 12-84 Month Terms
- Application Only Programs
Up To \$500,000

Financing As Low As:

- \$50,000 – \$749 Per Month
- \$100,000 – \$1,499 Per Month
- \$200,000 – \$2,999 Per Month
- \$300,000 – \$3,499 Per Month
- \$400,000 – \$5,999 Per Month
- \$500,000 – \$7,499 Per Month

Your soft costs for rigging, dust collection, and electrical can be included in the package with just 1 payment due at signing. **No out of pocket surprises.**

Talk with your Coffey Machinery expert about the best option for your needs.





FINANCE/LEASE APPLICATION

Questions, contact Thomas Strickfaden at 586-850-2548 **Fax Completed and Signed Application to 704-353-7263 or tstrickfaden@leasefinancialllc.com**
IMPORTANT INFORMATION: If you are applying for individual lease or for joint lease with another person (including a joint account or an account that you and another person will use) complete all sections providing information about each individual applicant, joint applicant or user. If you are applying to guarantee the obligations of a business, complete all sections providing information about yourself. **Persons providing information who are not Applicants, Guarantors, or Company Authorized Signers should not sign this statement.**

BUSINESS INFORMATION					
Legal Business Name		DBA Name		Tax Identification No.	
Street Address (no P.O. Boxes)			Billing Address (no P.O. Boxes)		
City/County/State/ZIP					
Equipment Location (if different from above): Street Address/City/County/State/ZIP					
Contact		Phone No. ()		Fax No. ()	
Nature of Business		Time in Business	Time as Owner	No. of Employees	Gross Annual Revenue
Is your business sales tax exempt? If "YES" indicate tax exempt number: <input type="checkbox"/> NO <input type="checkbox"/> YES				E-Mail Address	
<input type="checkbox"/> Sole Proprietorship <input type="checkbox"/> Individuals applying jointly for business purpose lease <input type="checkbox"/> General Partnership <input type="checkbox"/> Limited Partnership <input type="checkbox"/> Corp. or Ltd. Liability Co. Date of Org. _____ State of Org. _____ <input type="checkbox"/> Other: _____					

GUARANTOR INFORMATION (ALL 20% OR MORE OWNERS AND OTHER GUARANTORS)						
Principal/Partner/Officer		Title	% Ownership	Date of Birth	Social Security #	U.S. Citizen <input type="checkbox"/> YES <input type="checkbox"/> NO
Home Address		City	State	ZIP	Home Phone ()	
Billing Address (if different)		City	State	ZIP	Phone ()	
Principal/Partner/Officer		Title	% Ownership	Date of Birth	Social Security #	U.S. Citizen <input type="checkbox"/> YES <input type="checkbox"/> NO
Home Address		City	State	ZIP	Home Phone ()	
Billing Address (if different)		City	State	ZIP	Phone ()	

EQUIPMENT INFORMATION	
Please indicate the equipment you are planning to acquire:	
Equipment Supplier:	Estimated Total Equipment Costs: \$
Structure: <input type="checkbox"/> Nominal (e.g. \$1) Purchase Option Lease <input type="checkbox"/> Fair Market Value Purchase Option Lease	TERM _____ Months

BANK REFERENCE			
Bank Reference Name		Account/Loan Officer	Phone No. ()
Account type: <input type="checkbox"/> Checking <input type="checkbox"/> Savings <input type="checkbox"/> Loan <input type="checkbox"/> Line of Credit		Account No.	Average Balance (6 months)
		\$	\$

"You," the "Applicant" (both terms include the business entity as well as all of the individuals named above), certify to us that you are applying for credit for business reasons, and not for personal, family or household purposes. Applicant authorizes, C.R. Onsrud Finance, (CROF), its Agents or Assigns, to obtain information from others concerning Applicant's credit and trade standing, including Applicant's personal credit report, and other relevant information impacting this application, and if the Lease is approved, from time to time during the term of the Lease. In addition to the information requested on this application, CROF may subsequently request additional information from Applicant. **IMPORTANT INFORMATION: Except as otherwise prohibited by law, you agree and consent that the affiliates and assigns of CROF may share with each other all information about you that CROF has or may obtain for the purposes, among other things, of evaluating credit applications. Under the Fair Credit Reporting Act there is certain credit information that cannot be shared about you (unless you are a business) if you tell CROF by writing to C.R. Onsrud Finance, 120 Technology Drive, Troutman, NC 28166. Please provide your name, address, social security number and account number(s).** As an authorized agent of the applicant company, you represent that you have reviewed this document and the information herein is true, correct and complete. A photostatic copy of this authorization shall be as valid as the original. **North Carolina Residents Only:** The North Carolina laws against discrimination require that all creditors make credit equally available to all creditworthy customers, and that credit reporting agencies maintain separate credit histories on each individual upon request. The North Carolina Civil Rights Commission administers compliance with this law. **New York Residents Only:** A consumer report may be requested in conjunction with this application. Upon your written request, you will be informed whether or not a consumer report was requested and if such report was requested, informed of the name and address of the consumer reporting agency that furnished the report. Subsequent consumer reports may be requested or utilized in connection with an update, renewal or extension of the credit for which this application is made. **Vermont Residents Only:** You authorize CROF, its Agents or Assigns, to obtain credit reports about you now and in the future for all legitimate purposes associated with this application or the account including, but not limited to: (a) evaluating this application; and (b) renewing, reviewing, modifying, and taking collection action on the account. **Important Information About Procedures for Opening A New Account:** To help the government fight the funding of terrorism and money laundering activities, Federal law requires all financial institutions to obtain, verify, and record information that identifies each person who opens an account. What this means for you: When you open an account, we will ask for your name, address, and date of birth, business documents, and other information that will allow us to identify you. We may also ask to see your driver's license or other identifying documents.

COMPANY AND GUARANTOR SIGNATURES (SIGN BOTH PLACES BELOW)		
We/I certify that we/I have read and agree with applicable terms and conditions above.		
Company Authorized Signature	Title	Date
Company Authorized Signature	Title	Date
Guarantor / Owner / Individual Signature	Guarantor / Owner / Individual Signature	



2024 | SALES, SERVICE, INSTALLATIONS,
AND TRAINING SOLUTIONS

Imagery, photography, logos, and copy displayed in this brochure are used in partnership between Coffey Machinery, LLC and the businesses advertised herein.

All copyrights, patents, and trademarks of content included within this brochure are property of their respective owner.

Coffey Machinery, LLC.
5 Shuler Street
Amsterdam, New York 12010

www.coffeymachinery.com

CONTENTS

A Message From Our CEO

P. 8

About Coffey Machinery

P. 9

Training

P. 10

The Regions We Cover

P. 11

Solid Wood Processing Machinery

P. 12

Panel Processing Machinery

P. 40

Software Solutions

P. 60

Spray Lines

P. 62

Proudly Representing Industry Leading Brands



CONTENTS

Sanding Machinery

P. 72

Inventory Management Machinery

P. 82

Clamping, Handling, and Transport Machinery

P. 84

Drilling and Dowel Insertion Machinery

P. 92

Classical Machinery

P. 98

Pressing Machinery

P. 114

Specialized Solid Wood Machinery

P. 116

Dust Collection and Waste Management

P. 120

Delivering Results And Solutions For Your Business



A Message From Our CEO

Thank you for considering Coffey Machinery as your machining solutions provider. Our purpose is to meet the needs of our customer's production challenges by providing industry-leading machines, first-class service, training, and support.

Our team stands ready to offer solutions for your woodworking and plastics machinery needs. We offer high-technology CNC's, Edgebanders, Beam Saws, and Inventory Retrieval Systems, as well as the finest solid wood machinery in the industry—all here to make you more profitable and productive.

— Bring us your challenges and count on us to deliver results and solutions for your business!

Sincerely,



Lance Orcutt
President & CEO



*Machines marked with the star symbol are located at
Coffey Machinery's showroom in Amsterdam, New York.*

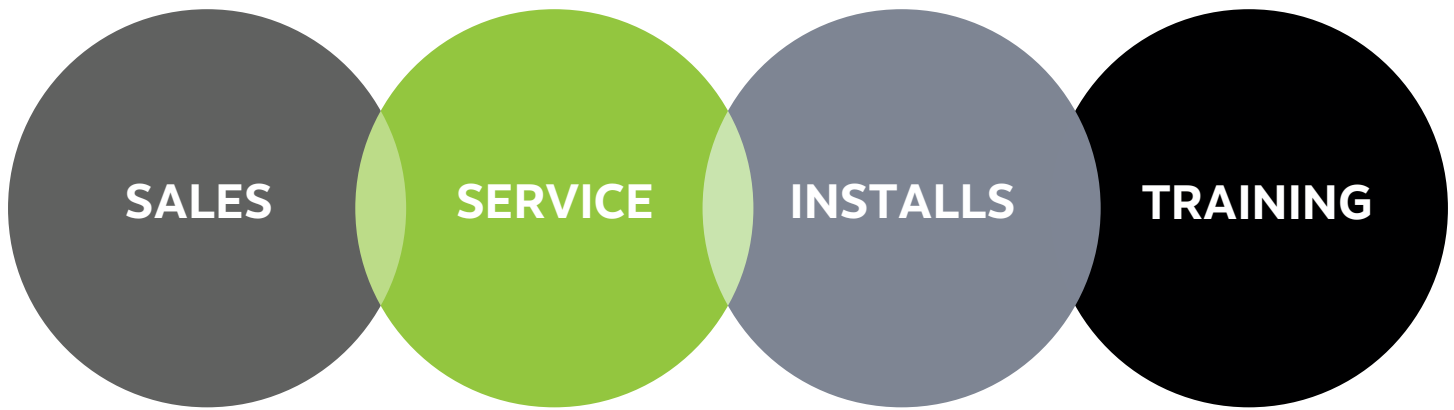

Delivering Sales, Service, Installations, and Training Solutions

With well over 100 years combined experience in the woodworking manufacturing industries of the tri-state area, Coffey Machinery is your provider for machinery, software, and ancillary items. We have the single largest install base of high technology solutions around.

The Coffey Machinery Promise

We guarantee to provide all of our Coffey Machinery customers with incredible service beyond the sale. Should one of your machines go down for any reason – delayed parts, servicing, or otherwise – and cannot be up and running within 5 business days, we will run your project for you in our functional showroom located in Amsterdam, New York.

Serving New York, New Jersey, Maine, Pennsylvania, Rhode Island, Vermont, New Hampshire, Connecticut, and Massachusetts.



LEARN MORE



Hands-On Training

Let our experts train your staff so your business can be more proficient.

Coffey Machinery offers comprehensive training programs on our machinery to our customers. Training is completed in-house at our state-of-the-art factory and training center in Amsterdam, New York. Students will receive education from industry experts on real-world projects through a variety of classroom and hands-on training.

Coffey Machinery stands firmly behind each and every product we sell. With an extensive variety of brands, makes, and models in our factory, students will become proficient across the machinery that your business will use on a daily basis – making your business stronger, more efficient, and more profitable.



Our Territories

New York

New Jersey

Vermont

New Hampshire

Maine



Pennsylvania

Massachusetts

Connecticut

Rhode Island

 Visit our fully functional factory showroom in Amsterdam, New York.

THINK WEINIG

LEARN MORE



The World's Leader for Solid Wood Processing

WEINIG is a full-service provider for solid wood and panel processing: solutions for cutting, gluing, profiling, jointing, edgebanding, and CNC technology. Coffey Machinery is proud to represent these high-performance, efficient machines and systems, as well as innovative services and customized concepts that cover the entire production cycle from raw material to finished product.

Optimal quality and profitability give our customers and partners in small businesses and industrial operations a decisive edge in the global competition. WEINIG's success in wood processing is the result of listening to our customers and the demands of the marketplace.

Coffey Machinery proudly presents WEINIG's comprehensive range of solid wood processing machinery. As the world leader in solid wood processing, WEINIG offers an unparalleled selection including Rip Saws, Planers/Moulders, Cross-cut Saws, Scanner Systems, and an array of other woodworking machinery. Elevate your woodworking capabilities with our lineup, designed to optimize efficiency and precision, ensuring each project is of the highest quality.

WEINIG Products

Planers/Moulders

Rip Saws

Cross-Cut Saws

Tool Grinding

Scanner Systems

Finger Jointing Lines

Gluing Presses

CNC Processing Centers



LEARN MORE



Moulder Master



Smart Touch



Rondamat 1000 CNC

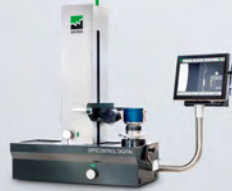

OptiControl Digital



Powermat 1500

★ View this setup in Coffey Machinery's showroom.

WEINIG System Plus: The Complete Solution for Production of Mouldings

WEINIG is the leading technology supplier for industrial and small scale processing of solid wood products. Worldwide availability of expansive services combined with economical system solutions make WEINIG the all-around ideal partner for profitable manufacturing. Particularly, when confronted with the challenges of quick delivery times, short production runs and satisfying individual customer requirements, WEINIG shows its competence and ingenuity, not only in reference to machine technology, but also in consideration of the complete production infrastructure.

With the WEINIG System for production of mouldings you will meet these daily challenges with ease. The perfect coordination of individual work-steps within the process chain guaranties highest quality and efficient use of resources.

Moulder Master: The quickest way from an idea to the finished product

The efficient organization of the working environment plays an ever increasing role in optimizing the manufacturing process. Moulder Master links together all processes which take place prior to production. The necessary information will be sent to the required locations in the tool grinding room or the production area. Errors will be minimized, process security improved and consistent high quality of the end products ensured. In this manner, Moulder Master supports efficient and economical manufacturing with the moulder.

Key Functions

- Fully integrated 2D-CAD for drafting profile and tool contours
- Data bases for management of profiles and tools with search functions
- Integration of moulder data with display of spindle arrangement
- Data exchange with the WEINIG Template maker, OptiControl Digital and PowerCom System

Benefits

- One system for preparation of all production needs
- High precision through CAD data
- Efficient management of profiles and tools
- Centralized accumulation of knowledge from various departments
- Automating individual work-steps

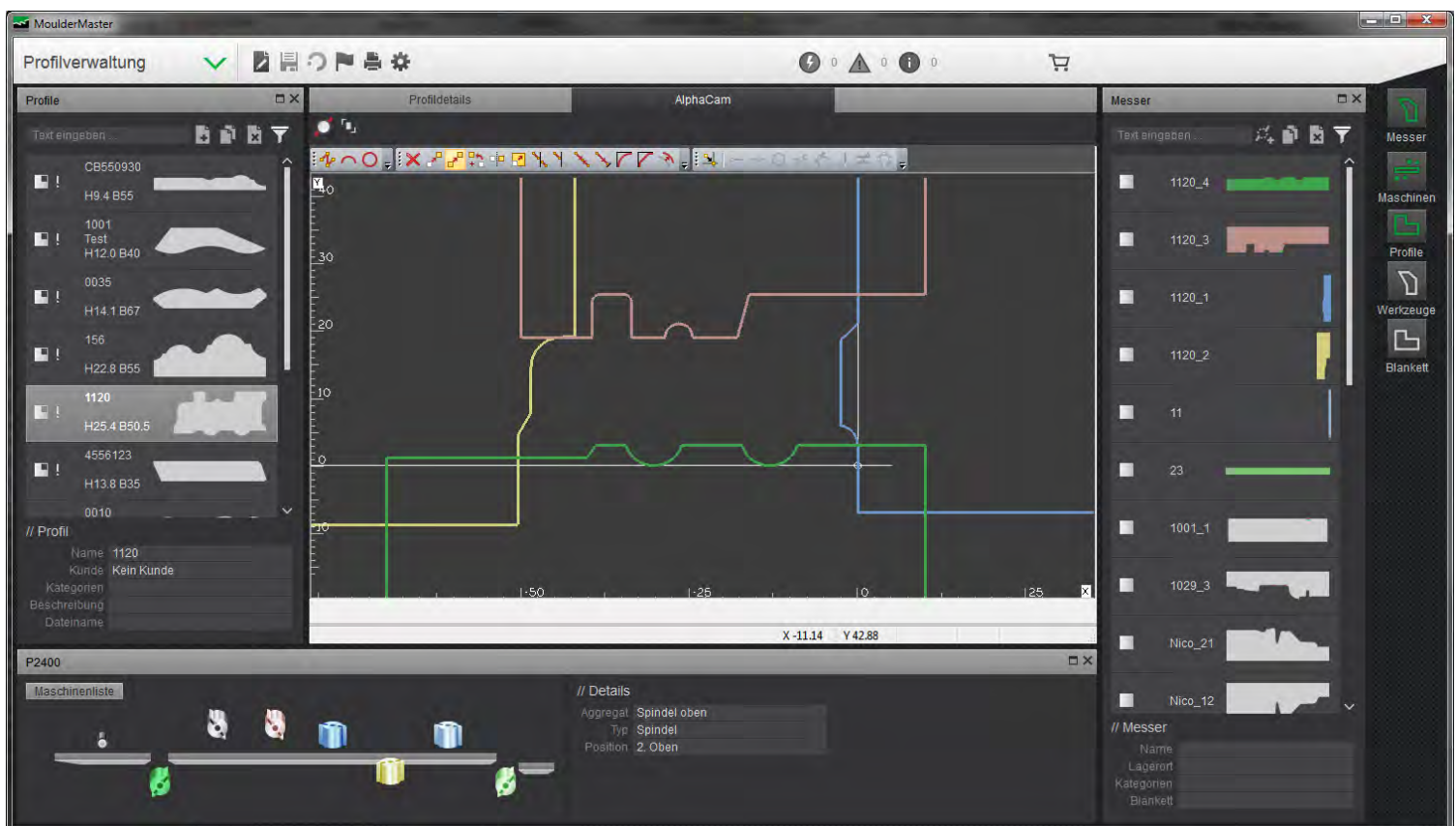

Planers/Moulders



The Cube 3 automatic planer is the perfect machine for four-sided planing. Cube 3 is ten times faster than conventional machines where parts have to be repositioned several times. From small strips to large beams: with the Cube 3 you can plane a vast range of dimensions all in an efficient one-person operation.



The Profimat 50 is your answer for efficient and precise planing and profiling. The Profimat 50 can be equipped with an intelligent control package for reproducible results at the push of a button. The intuitive operability of the Profimat 50 ensures short setup times, high user safety, pleasant operating comfort, and consistently safe working.



The Powermat 700: Improved ease of operation and very short setup times offer the highest degree of flexibility. With 8,000 RPM spindle speed in standard the new Powermat 700 offers even more performance. This means more linear production every day without sacrificing high surface quality. Compared to conventional moulders, the production increase is up to 15%.



The Powermat 1500 is a moulder that optimizes profitability for your operation. The Powermat 1500 offers up to 12,000 RPM with perfect processing down to the last detail. With state-of-the-art HSK technology, fast changeovers and handling of small orders are a breeze. Experience the full capability of a WEINIG moulder with the Powermat 1500.



WEINIG Powermat 3000

WEINIG Powermat 3000 is reliable, powerful, and versatile. From the construction of the high-quality cast iron base, to the programming of the intuitive control, and the production of the high-precision spindles, to the precise assembly of all elements, the Powermat 3000 offers ideal conditions for serial production with maximum surface quality.



WEINIG Hydromat 3000: The robust moulder for entry into the Hydromat series. Whether planing beams and/or producing mouldings – we can build the ideal Hydromat 3000 for your requirements. With feed speeds of up to 100 m/min, jointing technology and robust pressure elements, it offers the best solution for high speed production in legendary WEINIG surface quality.



Rip Saws



The WEINIG VarioSplit 900 is a flexible band resaw for high demands in terms of saw cuts and service life. With the highest dimensional accuracy, the VarioSplit is in a class of its own. Reduced set-up times as well as quick and easy measurement settings allow for maximum productivity.

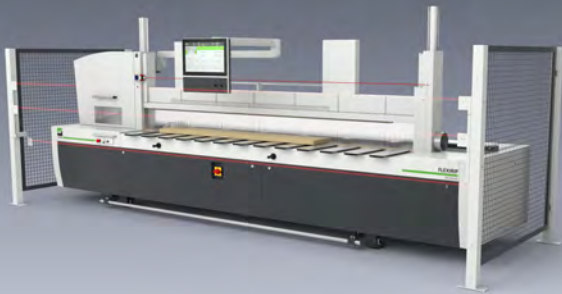

When it comes to cutting planks, boards, and panels, the FlexiRip has established a reputation as an efficient and flexible longitudinal circular saw. Customers particularly appreciate the high levels of flexibility, the optimal wood recovery, and the one-man operation.



WEINIG UniRip 310: The robust and highly versatile multi-blade rip saw. The new multi-blade rip saw impresses with its robust design and ease of operation. With a cutting height of up to 110 mm and high feed speed, the machine is suited to a wide range of tasks. The patented QuickFix system takes care of retooling in no time. Attractive pricing with a strong standard model and a number of intelligent options.



WEINIG Rip Saws: Strong solutions to make your cutting even more profitable.

Rip Saws

The compact, robust VarioRip 310 with 1 or 2 moving blades, is the ideal machine for small and medium-sized operations. Whether as a multi-blade or optimizing rip saw, the new VarioRip 310 impresses even in the standard version with high-quality equipment and excellent user-friendliness. The patented Quickfix clamping system enables rapid retooling.



The WEINIG ProfiRip 340 is a strong platform, whether as an optimizing rip saw or multi-blade rip saw. Well-equipped in the standard version and with a range of intelligent options. The use of special saw blades allows glueable cuts to be produced whether ripping or edging. The extraordinarily powerful circular saws allow the most difficult materials to be processed.



The ProfiRip 450 features high-performance, multi-blade rip saws with up to 6 adjustable saw blades for optimal wood recovery. Its versatility makes it ideal for all operations – from interior fittings to the furniture industry, and from solid wood panel production to the sawmill. Excellent user-friendliness, the shortest setup times, and optimal profitability.



WEINIG ProfiRip 610: A powerhouse for the highest demands in modern production. Ideal in the performance range of up to 140 mm cut height. Extreme flexibility and optimal wood recovery with up to 6 adjustable saw blades. Optimal production performance with processing widths of 610 mm. With feed speeds of up to 80 m/min, the ProfiRip 610 represents optimal performance, flexibility, and productivity.



WEINIG ProfiSplit 1100: High-Performance Band Saw

The modern high performance band saw as single or twin resaw in the performance range up to 80 m/min. Better material yield, more effective chip extraction and improved user-friendliness - the new ProfiSplit 1100 band resaw opens up a whole new range of prospects. The intelligent PC controls make operation fast and convenient and offer a range of adjustment options. The perfect interaction of the new feed unit with freely selectable limit stop side and the accurately positionable saw units allow you a free choice of how the inserted wood should be cut.

Maximum productivity and highest flexibility are achieved at all times with the powerful performance package. Highest reliability and quality as well as the premium service of the world market leader complement the technical capacity of the ProfiSplit.

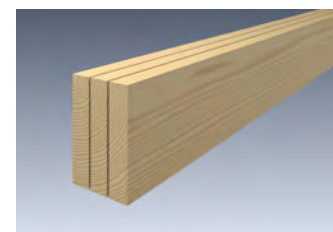
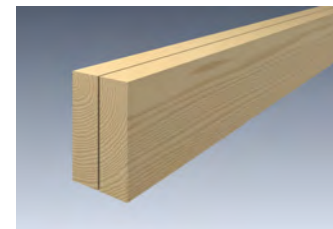
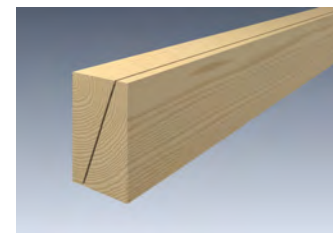

Under-Table Cross-Cut Saws

The OptiCut C 50+ convinces with reliable technology made by WEINIG. Its performance is particularly evident when cutting small and medium-sized cross sections. The saw also scores with regard to safety: 2-hand control, protection shield and downholders guarantee for highest safety. OptiCut C 50+ can be expanded any time with a variety of options.



The OptiCut C 700+ is an excellent saw when cutting heavy/hard timber with big cross sections at high cutting frequency. The saw also scores with regard to security. 2-hand control, protection shield and downholders guarantee highest safety. It can be expanded any time with a variety of options. Moreover, it can be easily linked to other WEINIG machines or integrated into production lines.

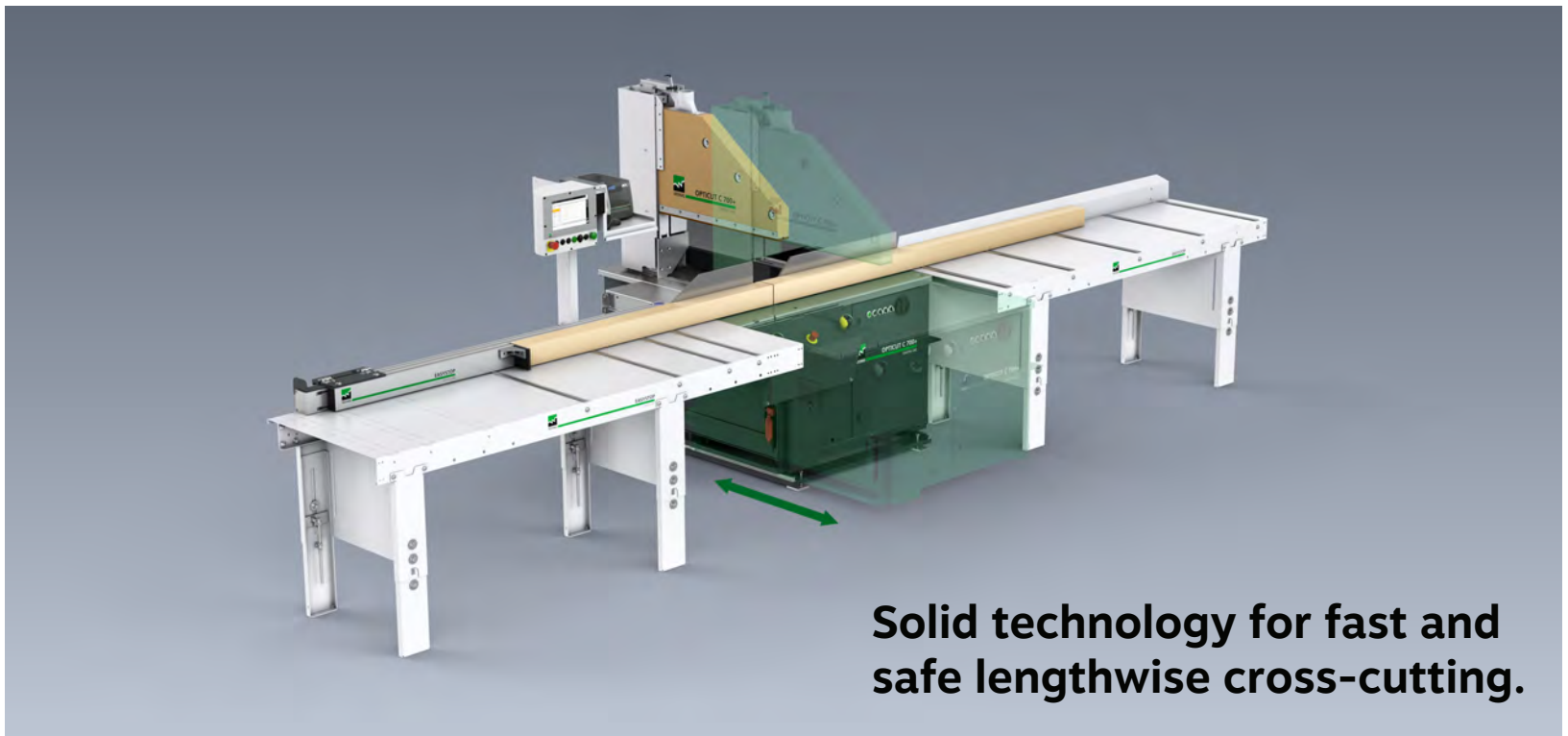

Solid technology for fast and safe lengthwise cross-cutting.

Cross-Cut Saws with Positioning Pusher



The UniCut P and the UniCut S are the ideal machines for fixed length cutting. Excellent workpiece positioning provides the prerequisite for optimum cutting quality. Transport, positioning, fast and precise cross-cutting with incredibly simple operation. This optimizing cross-cut saw is aimed at workshops that are deciding to invest in an automatic cross-cut saw for the first time.



The Opticut S 50 offers product-specific equipment options, intuitive operation, and effortless maintenance that make this machine suitable for practical use, and thus support countless companies in optimized lengthwise cutting. The main application of this saw is still general fixed length cutting of boards, scantlings, rods, strips and many different cross-section shapes and materials.

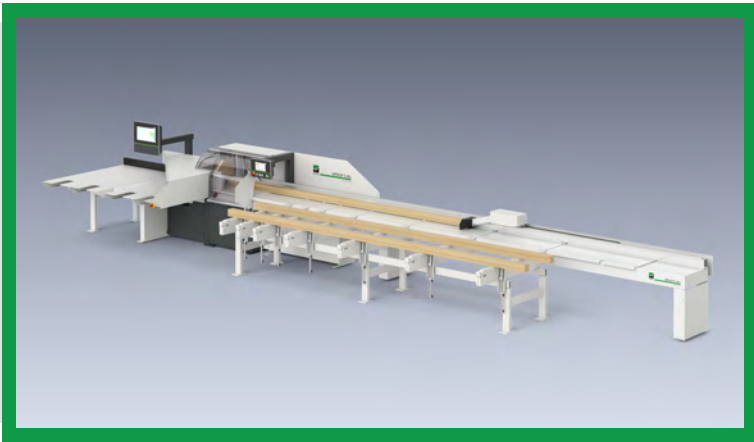

The OptiCut S 50+: Performance, flexibility and maximum safety. The modular design offers a perfect fit to your needs to give you the necessary flexibility for future extensions. This pushfeed saw is the right choice wherever packets or individual boards are cut in large quantities. Cut up to four times more than with a manual chop saw. Your production remains highly efficient combined with a maximum yield.



WEINIG Optimizing cross-cut saws with positioning pusher: As universal and diverse as the requirements of your customers.

Cross-Cut Saws with Positioning Pusher

The OptiCut S 90 is defined by its universality. Whether you want to cut packages, profiles or even rods – individually or as part of a series – all this is possible with the OptiCut S 90, usually without having to make adjustments to the machine. The entry-level model can handle weights of up to 100 kg with a positioning precision of ± 0.5 mm. Cutting in packages leads to a multiplication of the cutting capacity.



The top model OptiCut S 90 Speed impresses with pure performance and breathtaking speed in the production process. The focus is on maximum material yield through full optimization. The return stroke, positioning and cutting speed in combination achieve a capacity that was previously only possible with through-feed saws. The OptiCut S 90 is flexible and precise, with ultra high cut accuracy.

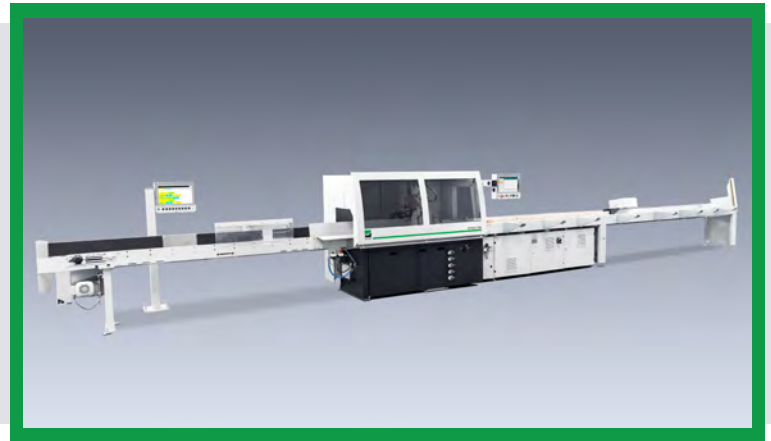

The OptiCut S 90 XL is designed for working with large sizes. The machine can handle workpieces or workpiece packages weighing up to 150 kg and with a maximum cross section of 280 x 180 mm or 420 x 40 mm. Even with large cross-sections the machine achieves a high cutting performance and length accuracy. Suitable options are available for the OptiCut S 90 XL.



WEINIG OptiCut S 90 series: Unlimited range of applications and high productivity combined in one series.



WEINIG OptiCut 200 Series

Optimizing Cross-cut Saws

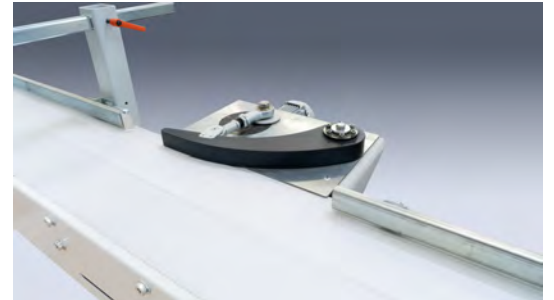
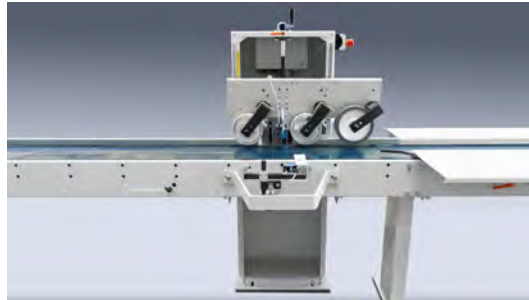

OptiCut 200

If a push-feed saw no longer meets the customer's capacity requirements in single-board operation and it is not possible to operate in pack cutting mode because defects must be cut out or random lengths have to be processed, the OptiCut 200 offers an entry-level option into a new class of optimizing cross-cut saws. It has the primary features of WEINIG DIMTER through-feed saws such as superior precision, advanced technical availability and, last but not least, low operating costs. Reliably high daily capacity, full optimization as standard and completely trouble-free operation are essential features of the OptiCut 200.

OptiCut 200 Exact

When it comes to maximum length accuracy, the OptiCut 200 Exact is the best choice. With its special measuring method, it achieves length accuracy of up to ± 0.5 mm - for up to 8 preferred lengths. The accuracy of the OptiCut 200 Exact does not, however, compromise its high daily capacity! Intelligent saw blade control can reduce tears and achieve cutting surfaces of the most superior quality. To achieve maximum squareness of the cut, active lateral pressure is also available, which additionally presses the workpiece against the stop guide. Maximum precision and, in many cases, the avoidance of an additional work step are the result.



WEINIG OptiCut 260

High performance without compromising on standards is the advantage that the OptiCut 260 offers you. Independently-driven measuring wheels only measure when the wood is in motion. Uncontrollable slippage or belt elongation in the infeed system do not distort the cutting results as the machine cuts at precisely the intended point. This avoids errors with good quality wood and guarantees precise fixed lengths regardless of the wood quality. Standard conveyor belts reduce the operating costs of the machines, which are profitable all-round.





WEINIG OptiCut 450 Series
Optimizing Cross-cut Saws

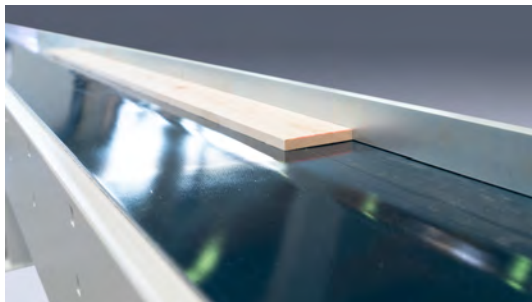

OptiCut 450

The OptiCut 450 can handle almost any quality of wood. This powerful machine is designed for consistent high production even when using lower grade or twisted wood. The length measurement of the entire work piece is carried out before the first saw cut. Thanks to drive-independent measuring wheels, faulty measurements due to slippage or belt elongation are ruled out. In combination with the intelligent optimization software, this guarantees maximum material yield. An additional measuring wheel in front of the saw blade ensures maximum cutting accuracy.



OptiCut 450 FJ+

The OptiCut 450 FJ+ is specially designed for finger jointing applications. The model variant code FJ stands for Finger Jointing. This variant features a special feed system that safely transports even the shortest OK parts. Thus, at the end of the board, the machine still retains full control over short parts up to 110 mm, which are reliably transferred to the sorting system. In order to obtain the required output even with the shortest lengths, the OptiCut 450 FJ+ features the smart VarioSpeed infeed and the intelligently controlled high-performance waste gate even in the standard version.

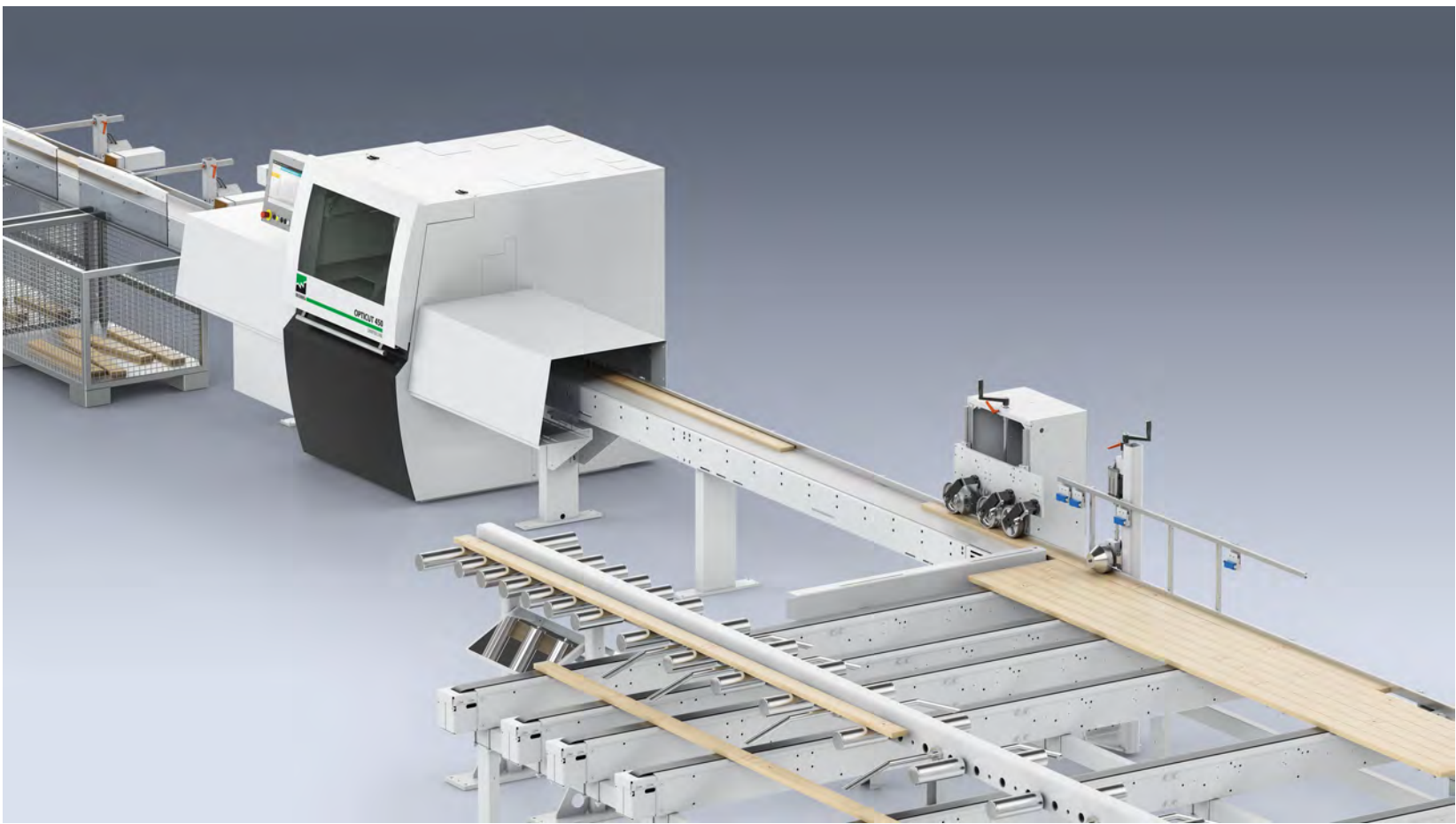

OptiCut 450 XL

The OptiCut 450 XL is the machine in the OptiCut 450 series for large and oversized wood cross-sections. Equipped with individually suspended and extra wide feed rollers, this optimizing cross-cut saw generates high torque and transfers it to large and heavy boards. Its strong overhead drive rollers follow the wood contour for consistent power transmission and maximum grip, enabling precise positioning. The standard configuration comprises a saw blade with a diameter of 700 mm for processing cross-sections up to 430 x 25 mm or 235 x 200 mm. The machine offers high cutting performance and length accuracy.



OptiCut 450 Quantum

The OptiCut 450 Quantum sets the standard as the fastest optimizing cross-cut saw in the world. The cross-cut saw is specially optimized for continuous high-performance operation. To live up to this reputation, the OptiCut 450 Quantum already features performance-enhancing and high-quality components as standard, like the smart VarioSpeed feed system or the intelligently controlled high-performance waste gate. Thanks to the installed measuring wheels, faulty measurements due to slippage or belt elongation are ruled out. Individually suspended overhead feed rollers with HighGrip rollers, specially designed for the type of wood, apply pressure to the workpiece for accurate positioning.

Tool Grinding/Measuring



The OptiControl measuring stand is one way to gather the corrected tool geometry after grinding which we use to help set up machine functions. Connect OptiControl to our Powercom tool room link and Powercom prepared machines for fully automatic tool set up.



OptiControl Digital: Measuring reference points on the tool is essential for precise setting of the moulder and the production of high quality mouldings. The OptiControl Digital tool measuring stand is the perfect enhancement for the tool room requirements and due to the high precision measurements it paves the way for fast and error-free setup of the moulder.



WEINIG Rondamat 960: High precision grinding with a high level of repetition precision. Rondamat 960 can be adjusted flexibly to the parameters of the tool and offers true running accuracy of less than 0.005 mm! When it is supplemented with additional equipment packages, it becomes a customized tool grinder for profile cutter heads that you can no longer live without.

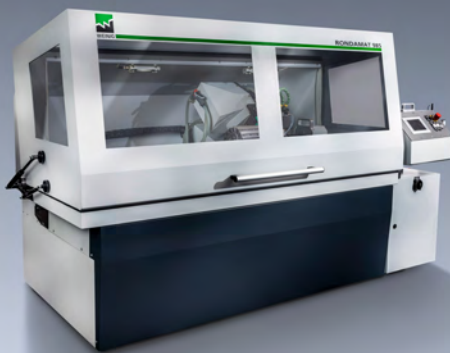

WEINIG Rondamat 985: Highest precision for sharpening planing cutterheads. The Rondamat 985 offers you ideal prerequisites for perfect sharpening of planing cutterheads up to 720 mm wide, regardless of whether it be a conventional cutterhead, hydro cutterhead or a shaft cutterhead. Because the knives are sharpened in the cutterhead it is even possible to subsequently joint hydro clamped tools.



WEINIG Rondamat 1000 CNC

The efficient organization of the work area plays an ever increasing role in optimizing manufacturing processes. Ultimately, the full performance potential of your moulders can only be achieved when the tools are sharpened, measured and available when needed. The Rondamat 1000 CNC grinds and sharpens tools fully automatically according to a CAD drawing created by Moulder Master providing the basis for producing accurate profiles on the moulder. In respect to efficiency and added value, the Rondamat 1000 CNC will raise your tool room to a new level.



WEINIG Scanner Systems: Recording Everything At A Glance

Fully-automatic, high-performance lines are being used increasingly in modern wood processing, even in rough mill applications. An upstream scanner is an integral component of the overall system. The scanner records the relevant timber data on all sides in the blink of an eye (knots, etc.) and supplies this to the machines downstream, such as rip and cross-cut saws, at full production speed. Without automatic recognition systems like this, the cutting performance of the overall systems would be unimaginable. This places the highest demands on the control technology.

The WEINIG development departments provide solutions for highly automated production lines. WEINIG guarantees reliable production processes - for hardwood and softwood applications. WEINIG offers the right configuration for every application.



Scanner Systems

The new EasyScan Smart has been designed for two applications: cross-cutting (Easyscan Smart C) and sorting (Easyscan Smart S) for maximum production control and transparency of your manufacturing process at an affordable cost. Expect optimal detection of any defects (holes, wane, and edge defects) on up to 4 sides. With the EasyScan Smart you can optimize your products by value, yield or production requirements.



In the R version of the CombiScan Sense, WEINIG has further increased the efficiency of its scanner technology for ripping applications. The two-dimensional optimization of the boards allows recovery to be significantly improved. Cross-cutting optimization is already predicted during the ripping optimization. The CombiScan Sense can be linked with various WEINIG machines, such as cross-cut saws, rip saws and sorting systems.



WEINIG EasyScan RT: Innovative ripping optimization. Its revolutionary concept features automatic moving cameras, which sets it apart from all competitor products. The number of sensors can be reduced drastically, cutting down costs to a minimum. The cross conveyor feeds the boards into the scanner, then holds them motionless for scanning. The two-dimensional optimization of the boards allows recovery to be significantly improved.



**WEINIG Scanner Systems:
The most profitable solution
for wood optimization.**

WEINIG Finger Jointing Lines: The Fastest Way To Create Higher Value

Finger jointing is recognized as the most stable method of wood length joints. And if you require this technology, there's no better exponent than WEINIG. WEINIG finger jointing technology is focused on maximum precision. This means minimal dimensional allowance, wood losses and operating costs. All systems are extremely user-friendly. This makes residual wood processing and upgrading by finger jointing profitable and easy for you!

The flexible modular design allows machines to be equipped according to your individual requirements. This enables high flexibility and customer-specific solutions, regardless of whether the systems have raw wood entry lengths, smaller or larger than 1,000 mm. WEINIG system concepts are designed to meet the highest demands in quality for all performance classes. Now is the time to take a closer look at these incredible finger jointing lines from WEINIG and create higher value in your business.



Finger Jointing Lines

The WEINIG ProfiJoint offers enormous performance potential for those starting out. Due to the modular design, the line can be upgraded to a shaper combination. Just one of the many plus points, including the quick return it offers. Regardless of whether you are marking vertically or horizontally with pre-scorers, the ProfiJoint range uses the same equipment as the high performance models.



WEINIG Ultra/Ultra TT 1000: The powerful mid-level option. With a manually or automatically operated turntable running along the line, this is the perfect solution for commercial use of residue wood in medium-sized businesses. The standard dimensions for this production line are as follows: wood widths of 205 mm and raw wood lengths of 150 to 1,000 mm with the option up to 1,500 mm.

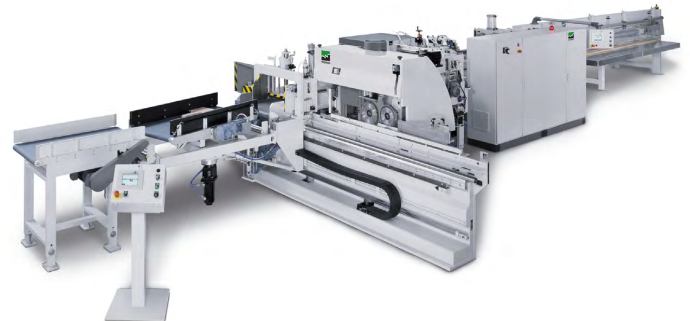

WEINIG HS 2000 - 6000: A new generation of long timber horizontal finger jointing lines. Infeed lengths of up to 6 meters can be processed with HS. This means that the line reaches a shaping capacity of 80 parts/min. Your benefits: Very high quality end products - as a result of the modular construction of this generation of lines, the components of your finger jointing line are totally adjusted to your timber feed in products and the final goods.

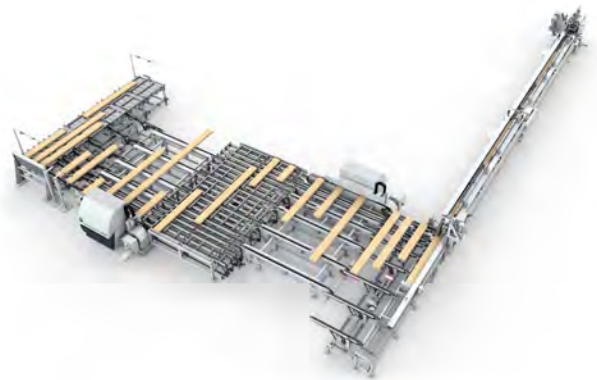

WEINIG Through-feed press: Your press for almost all glued-wood construction products. Using the through-feed press DKK, the feed-in line EUB and the following edging saw, you can press all glued-wood products into a perfect strand and, if needed, cut them to fixed end lengths with the following edging saw. Because of the high speed of the strands from up to 160 m/min, the through-feed press DKK is also suitable for producing glued beams in high speed lines.



WEINIG Gluing Presses

Glue solid wood and increase your added value! By increasing the depth of production but also by possible processing scrap wood, WEINIG is continuously developing and improving their systems and machines to meet your needs of your production process. For an optimum added value, panels are produced perfectly aligned as a result of an intelligent pressing process. This helps save material, minimizes post-processing and saves you money. In addition, the glue is applied in a very precise way, which helps to save glue and to reduce cleaning. This guarantees a smooth and secure production process. Automatic feeding systems and high frequency technology that reduce curing times, e.g. for PVAc, to a minimum, are provided as standard.

A variety of applications, from floorings to traditional furniture and DIY panels to mini beams, WEINIG offers you the perfect technical solution out of its portfolio of gluing presses. All machines can be optimally equipped for each individual application. This includes, for example, various gluing systems, pre-cutting solutions, mechanizations and equipment for modern glue systems.



Gluing Presses

The ProfiPress L II is ideal for all manufacturers of high-quality solid wood panels. It is unique in its combination of flexibility and productivity with outstanding quality at the same time. With the ProfiPress L II, even small and medium-sized companies are able to glue economically. Extremely short pressing and change overtimes and fastest curing ensure a high yield.



WEINIG ProfiPress T: Perfectly adjusted, the upper mid-range. ProfiPress T is our cycle press with cross feeding for wood lengths of 500 up to 6,400 mm. This intelligent technology can press panels of different lengths and widths at the same time in one cycle. Up to six pressing ribbons are possible within one press cycle, this allows you to achieve a maximum flexibility at a high level.

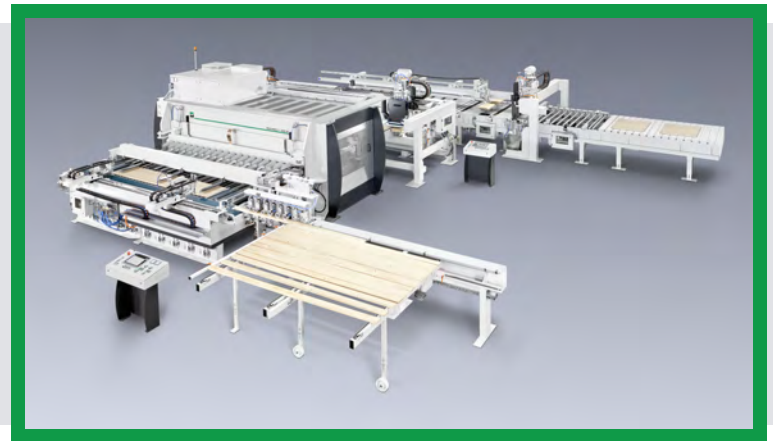

WEINIG ProfiPress LB: High-frequency gluing press for window scantlings, beams and panels with gluing heights of 160 mm. The modular system gives you the option of upgrading from a manual to a fully automatic production system. Its intelligent heating technology using high frequency ensures perfect gluing and product quality. Plus, the WEINIG Group's comprehensive product portfolio offers you all the options for system integration.



The production process of the future.

CNC Processing Centers

The new Conturex series opens up a whole new WEINIG world in the window and door industry, facade, and winter garden construction or furniture industry. Each Conturex takes on the tasks of up to 5 machines in a single pass. Extremely precise, fully automatic, and highly flexible.

Processing of all known corner connections, longitudinal contour processing, drilling, milling or insert milling – a clear case for the Conturex! Production types such as individual parts, series, or frame window production under completely new aspects: precise positioning with the pliers table, high flexibility thanks to tool magazines, and perfectly coordinated aggregate selection.

With the right software package and WEINIG as your partner for solid wood processing, we not only offer machines but also future-oriented, perfectly coordinated solutions for you.

This is what the WEINIG Conturex series offers you:

- Complete machining in one clamping
- Processing without setup time, even for small batch sizes
- Low-manner production through full automation
- Maximum flexibility thanks to large tool magazines
- Energy recovery modules for energy saving



CNC Machining Centers

Conturex Vario XS: By integrating the PowerGrip Motion 2D/3D pliers table, the universal Conturex Vario XS machining center is in no way inferior to its big brothers. The pliers table enables complete machining without setup in just one clamping and full freedom of movement in the X, Y and Z directions. Equipped with PowerGrip Motion 3D, workpieces up to 330 mm wide, but also the smallest dimensions, can be securely clamped and flexibly processed.



WEINIG Conturex Compact: Top performance even in the entry-level class up to part lengths of 6 m. The Conturex Compact offers all the advantages of the proven Conturex series at an affordable price, perfect for large window and door manufacturers, but also for smaller craft businesses. With the Conturex Compact System, the customer receives a coordinated and balanced complete package, consisting of machine, window construction software, tools and service.

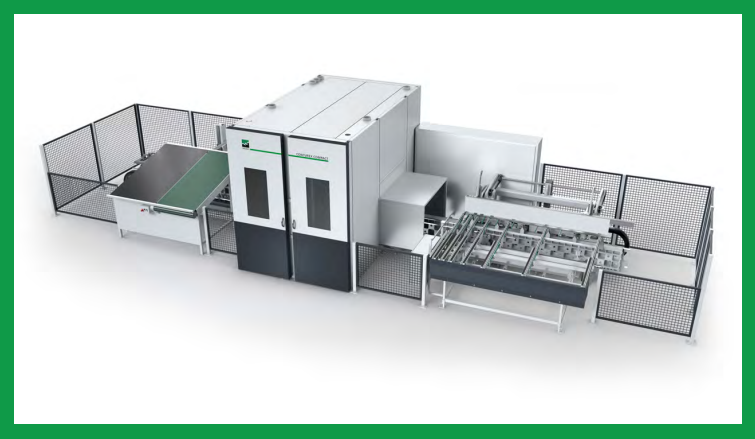

WEINIG Conturex Artis: The Conturex for the craftsman. With expanded workpiece clamping options. When processing window profiles on the Conturex Artis, even small shops don't have to compromise on quality and flexibility. As the "smaller brother" of the profiling center series, the new Conturex Artis offers all the advantages of the proven Conturex series at an optimal price to performance ratio.



**WEINIG Conturex series:
Top performance in all classes**

WEINIG Tools

WEINIG offers the right WEINIG cutter head for every desired surface and feed speed: as a tool with conventional clamping, as a classic tool with hydro-clamping, or as a modern PowerLock tool. WEINIG is guided by your precise wishes and requirements.

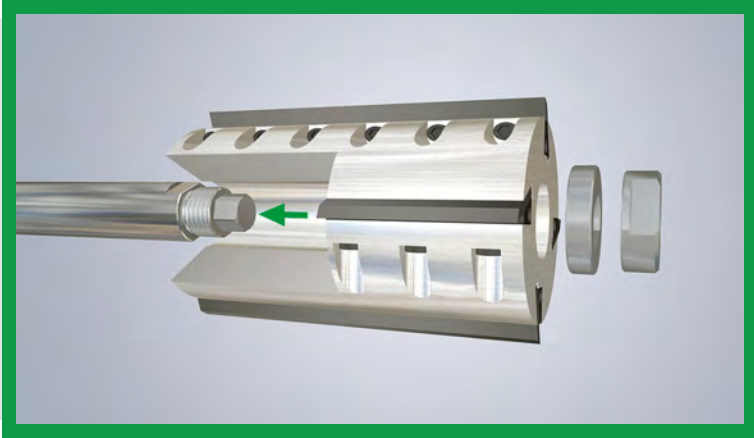

Tools with conventional clamping are attached to the spindle on the front end using a spindle nut. This limits the surface quality and feed speed. Although all cutting edges are in use, only the furthest protruding edge determines the surface.

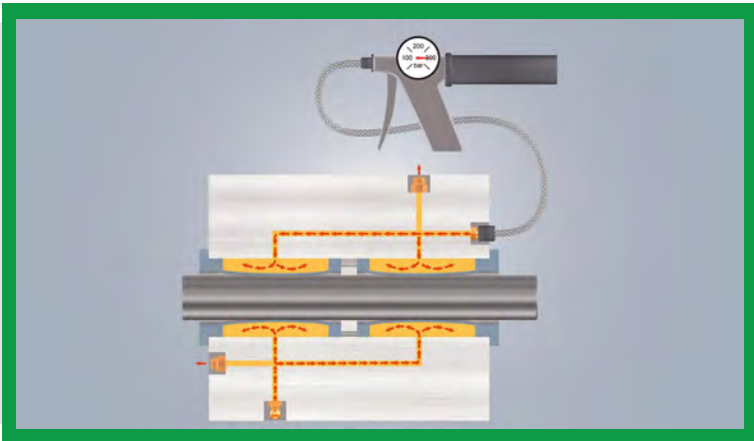

Original WEINIG hydro-tools: Perfect surfaces at high speed. WEINIG hydro-tools deliver outstanding surface quality at maximum feed speeds in series production. The tool system leaves no scope for tolerances for fit.



The WEINIG PowerLock systems enables speeds up to 12,000 RPM; twice the feed speed of conventional machines. The tools can be changed in seconds. With PowerLock, you can double your linear production per day, slash unit costs and shorten delivery times – all with outstanding surface quality.

Jointing Technology

To guarantee a consistently high surface quality for the work pieces, the joint land which appears on the tip of the knife must not exceed a specific width. This must not exceed 0.5 mm in softwood or 0.7 mm in hardwood. Jointing stones made of ceramic bonded mineral powders are used for HSS knives while special WEINIG jointing stones are used for carbide knives.

Requirements of Jointing: WEINIG moulders from the Powermat and Hydromat series fulfill moulder requirements.

For The Moulder:

- Heavy machine stand
- Even feed
- High capacity spindles
- Optimal spindle speed
- Jointing device

For The Tool:

- PowerLock or hydro-tool
- Precise straight or profile knife grinder (WEINIG Rondamat series)
- Optimally polished tool with ideal concentric tolerance below 0.01 mm
- Reduced angle on the knife back

Straight jointer with automatic jointing stone advancement.



Profile jointer with automatic jointing stone advancement.





LEARN MORE



Complete Solutions For Panel Processing

CNC machines, edgebanders, horizontal panel saws, vertical panel saws, and panel storage systems are some of the incredible tools you can expect from HOLZ-HER, a company of the WEINIG Group with over 100 Years of competency in panel processing. HOLZ-HER develops and produces state-of-the-art machines and equipment to cover the entire process chain from panels to final products.

HOLZ-HER's engineers number among the world's best. Their visionary imagination and exceptional skills guarantee that their machines are the highest performing, most flexible and safest in the world today. Customers appreciate their capability to develop and produce excellent products quickly, at equitable prices, and of high quality. Integrative, networked solutions are decisive for machining wood and panels worldwide.

Coffey Machinery is thrilled to provide an extensive range of panel processing equipment from HOLZ-HER. With CNC Machining Centers, Nesting Machining Centers, Vertical Panel Saws, Edgebanders, and more, shops can optimize precision and efficiency in their woodworking. Learn how these machines can offer your business the versatility and quality it needs to ensure every project reaches its full potential.

HOLZ-HER Products

CNC Machining Centers

Vertical Machining Centers

Nesting Machining Centers

Vertical Panel Saws

Beam Saws

Edgebanders

Automatic Panel Handling





HOLZ-HER Edgebanders: Top Equipment For Maximum Productivity

The edgebander is decisive for the high quality appearance of your furniture. By concentrating on essentials, HOLZ-HER edgebanding machines combine compact design with maximum automation, productivity, and superior finish.

The heart of any edgebanding machine is the glue application system. This is why HOLZ-HER always offers the perfect solution of every edgebander to ensure superior edge appearance. LTRONIC, the laser edging unit from HOLZ-HER which is unequalled in terms of speed and cost efficiency or the GluJet application system for mass production use of PUR glue for water resistant applications. Regardless of which high performance system you chose, optically invisible zero joints are a matter of course for HOLZ-HER customers.

Our Glu Jet System has a 3-year warranty. Ask us for details!



- Solid wood edging
- Veneer edging
- Plastic edging
- Aluminum edging
- Formica edging
- Melamine resin edging
- and many others

HOLZ-HER Glu Jet System

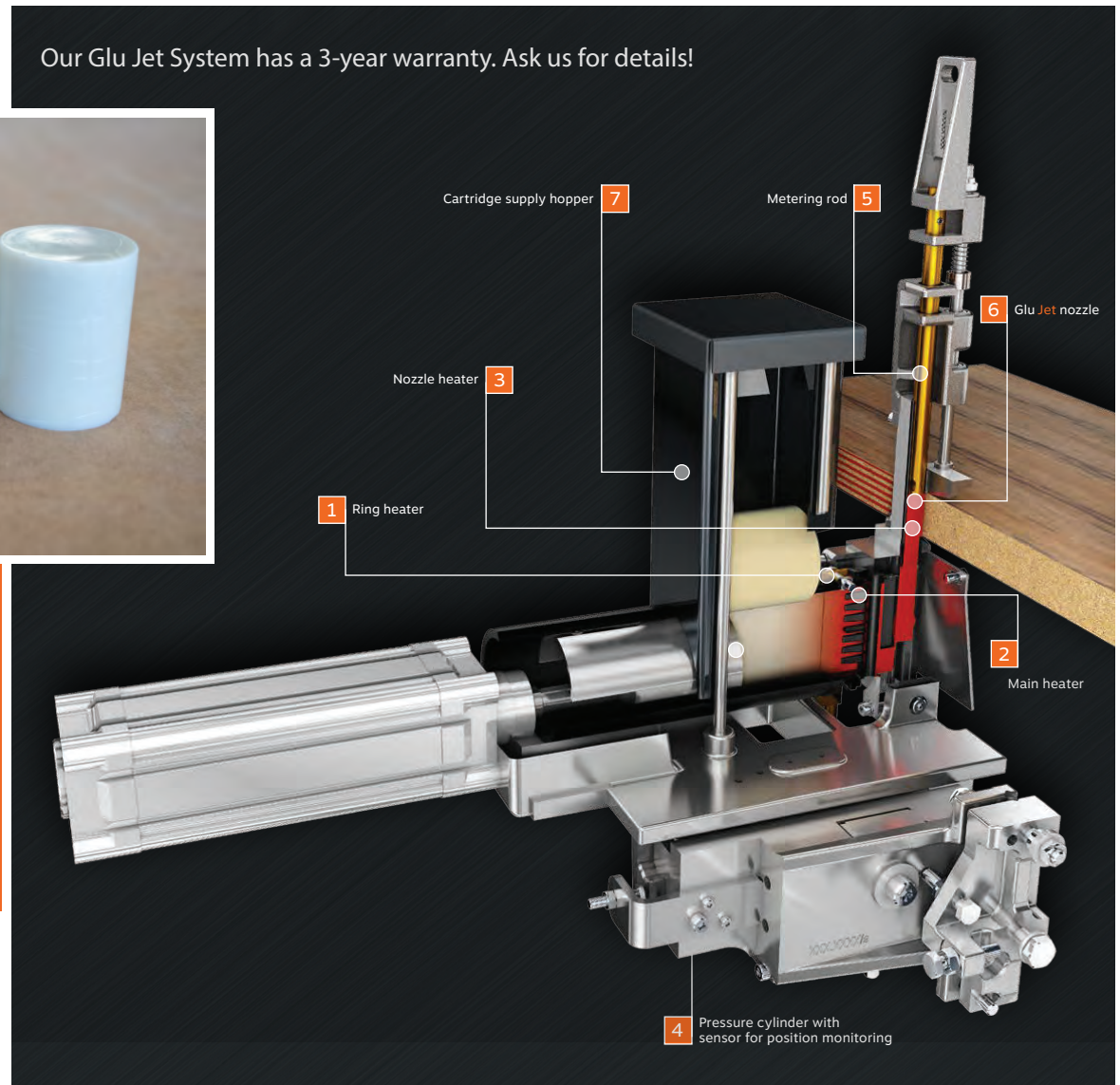

Three Independent Heating Circuits

- The ring heater [1] heats up the front section of the cartridge, expanding the cartridge and thus sealing the melting area hermetically.
- The main heater [2] heats the hot melt glue up to operating temperature. This is all accomplished in less than one minute.
- The nozzle heater [3] heats the entire steel nozzle up to the precisely desired temperature. This requires approximately 3 minutes.

Glue Application

- The pressure cylinder [4] presses the cartridge or the granules against the heater elements at a maximum pressure of 6 bars.

- The hot glue rises in the metering rod [5] and can then be processed. The control opens and closes the metering rod to meter the glue precisely under pressure to the Glu Jet nozzle [6].

Automatic Replenishment

- The pressure cylinder presses the cartridge or granules against the heater elements. After reaching a certain position, the sensor sends a replenishment signal to the control. As long as glue is being applied to a workpiece, charging is delayed until the work is finished. The pressure cylinder retracts automatically, a new cartridge or fresh granulated material drops from the cartridge supply hopper [7] in to the heating shaft where it is again pressed against the heating elements (Glu Jet automatic).

Edgebander ARTEA & STREAMER



The small, compact HOLZ-HER ARTEA 1020 edgebander operates with the same patented glue application nozzle also used in the larger models. The Glu Jet guarantees flexibility, exceptional edgebanding quality and simple handling. The easy-to-clean glue system is a great added value for you right from the start. The ARTEA 1020 is equipped with a 15.6" touch screen color monitor as a standard feature.



Within a compact space the ARTEA 1030 offers top equipment with an unbeatable price/benefit ratio. Jointing, gluing parts, corner rounding as well as a complete finishing area with radius scraper, flat scraper, buffer, and sprayer all within a space of only 3,700 mm. With a fixed speed rate of 9 meters per minute, edge thicknesses of 0.4-5 mm, and panel thickness from 8-50 mm, it covers a wide range of applications.



The basic idea behind the entire STREAMER series is to achieve excellent results within a very small space. At 3.96 meters the STREAMER 1054 C edgebander is extremely compact and has a great assembly package for perfect edging with invisible joints. PUR processing is also possible as a standard feature. STREAMER 1054 C can accommodate workpiece thickness up to 60 mm and edge thickness up to 8 mm.



The STREAMER 1057 XL C makes complete machining including corner rounding possible with three standard finishing units: a mechanical radius scraper, an application-controlled flat scraper as well as a buffing unit. A spraying unit to prevent adhesion of any glue or contamination residues is available as an optional feature only for the 1057 XL C. STREAMER 1057 XL C can accommodate workpiece thickness up to 60 mm and edge thickness of 6 mm wood standard capacity.

Edgebander AURIGA & SPRINT

Edgebander AURIGA 1308 XL Standard offers efficient and automatic complete machining at a professional level while remaining compact and affordable. One reason why this machine is one of our top sellers: the high sales volume makes it possible to offer this machine at an unbeatable price/benefit ratio. The AURIGA has a 60 mm working height including jointing and corner rounding.



The SPRINT 1327 offers variable feed from 10-18 m/min as well as automatic pressure beam adjustment. An edge feeder with synchronous drive and pressure unit are also standard features. Two models are available: The SPRINT 1327 classic includes equipment for jointing, corner rounding, and finishing work. The SPRINT 1327 can accommodate edge thickness of 8 mm wood standard capacity and up to 12 mm with separate tooling.



The SPRINT 1329 provides multifunction technology at the highest level. Motor-driven adjustable axes are used for the entire machine. Precisely reproduce dimensions at the touch of a button, without having to open the machine hood. The SPRINT 1329 can accommodate edge thickness of 8 mm wood standard capacity and up to 12 mm with separate tooling.



HOLZ-HER edgebanding machines combine compact design with maximum automation.

Edgebander ACCURA Series

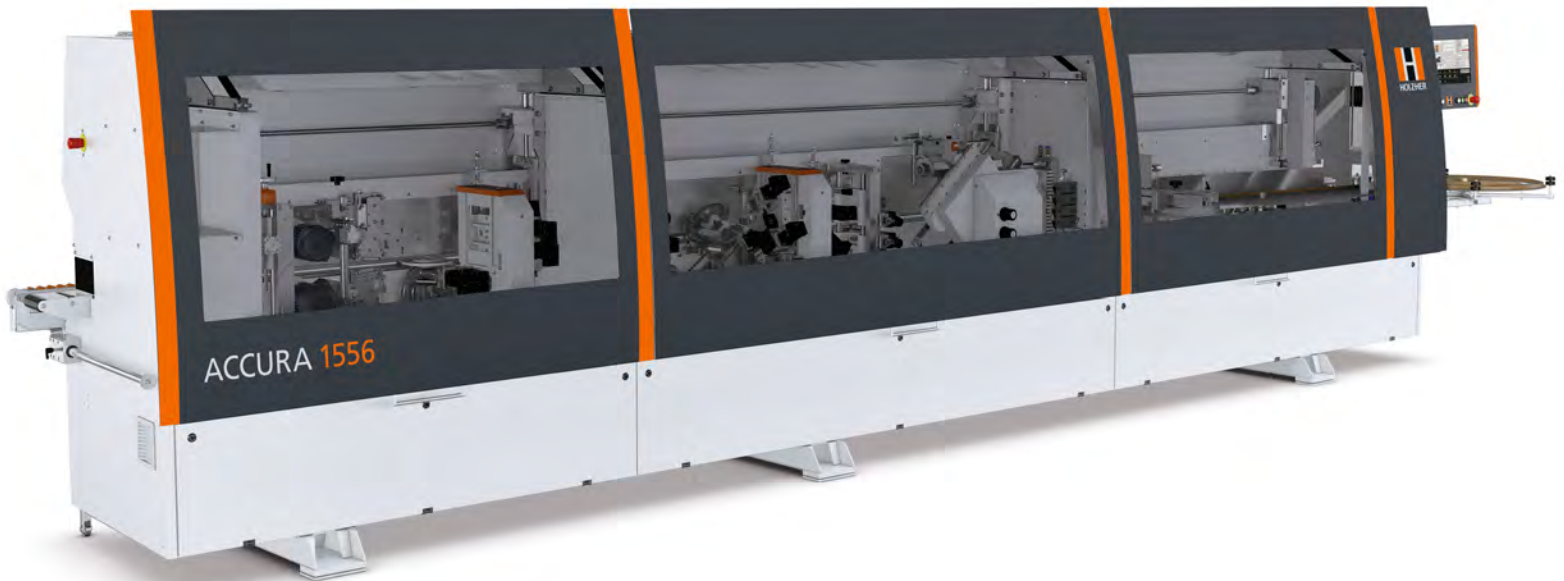

The ACCURA 1554 redefines edgebanding with more power, even more stability, as well as a machine design which sets accents. Requiring only 6.5 meters of floor space, the ACCURA 1554 offers professional complete processing with all required machining units. The ACCURA 1554 can accommodate workpiece thickness up to 60 mm, edge thickness of 8 mm wood standard capacity, and up to 15 mm with separate tooling.



The ACCURA 1556 premium model with two cutter units allows processing of solid wood edging with thickness up to 15 mm (optional 20 mm). The “grooving” model serves for fully automatic grooving in the vertical and horizontal direction. Standard equipment on the “flex” model includes a corner buffing unit for perfect edge finishing without any subsequent work. The ACCURA 1556 can accommodate workpiece thickness up to 60 mm and edge thickness up to 20 mm.

Edgebander LUMINA Series

Designed for highest requirements in terms of quality and flexibility, the edgebanders in the LUMINA series stand for complete processing of modern edging and panel materials with invisible joints. Program selection allows the machine to be set up without even opening the hood, so that it is ready for production immediately. The LUMINA series is your guarantee for absolute quality, flexibility, and productivity using high-quality glue, as well as laser edging.

In addition to our LTRONIC and Glu Jet systems, our LUMINA series offers everything required for a professional edgebander. Up to 18 NC servo-axes for maximum automation of all machining units with exact repetition at the touch of a button. Even the pressure and glue quantity settings can be made fully automatic and adapted to the specific requirement. The HOLZ-HER LUMINA with LTRONIC laser edging unit sets the highest professional standards for edgebanding.



CNC Machining Centers



The EVOLUTION 7405 4mat is a complete CNC machining solution in compact form. Unique in its class, the EVOLUTION 7405 4mat offers absolutely precise edge routing on all four workpiece edges and thus complete formatting for panel material. The solid design of the EVOLUTION series guarantees you maximum machining quality.



The heavy duty design and high precision components used in the entire EPICON series ensure perfect milling results. The EPICON 7135 is available with a machining depth of 1,500 mm. The 13 kW, 5-axis head and optimally equipped drilling assemblies make these machining centers the absolute high performer in your workshop.



EPICON 7235: the powerful all-purpose genius for any workshop. Machining lengths of 3,680 to 7,280 millimeters in X-direction and a remilling dimension of 1,650 millimeters are achieved with all drills and units. The extreme machining height of true 300 millimeters from the top edge of the vacuum cups with a generous Z-stroke of 565 millimeters provides sufficient clearance even for complex workpieces.



The EPICON 7335 5-axis CNC machining center opens new horizons for implementing your creativity. All drills and units achieve machining lengths of 3,680 to 7,280 mm in the X direction and edge routing dimensions up to 2,100 mm. The extreme machining height of 300 mm from the top of the suction cups with a generous Z stroke of 565 mm offers sufficient clearance even for complex workpieces.

CNC Machining Centers

The nesting CNC machine DYNESTIC 7505 enables highly efficient panel processing with the newest nesting technology in modern gantry design. With machining dimensions from 3,100 mm (3,700 mm) in X-direction and 1,580 mm in Y-direction, the optimized construction facilitates very short processing cycles with the best processing results in the same time.



The DYNESTIC 7532 gantry CNC machine expands the limits for nesting technology to new dimensions. Solid machine construction and technology at the highest level ensure high production capacity and precisely produced work. It has a high rigidity and therefore stands for high stability, especially for maximum loads.



The DYNESTIC 7535 CNC with 5-axis cutting spindle and a 2,200 mm deep grid table is the flagship of the new series with nesting machines made by HOLZ-HER. Even with this huge working depth, the moving stands in solid gantry design ensure utmost precision and optimum cutting results via two synchro drives.



The Power-Pin 7605 is one of the newest additions to the HOLZ-HER line. This bore and dowel insertion machine is a real performer with several options and configurations, including manual or motorized adjustment models. The Power-Pin 7605 bore and dowel insertion machine can be fully integrated into your nesting lines or added to a HOLZ-HER saw.



Vertical Panel Saws



The HOLZ-HER wall saw SECTOR 1254 is available in 2 frame versions with cutting length of 4,300 mm and cutting height of 1,900 or 2,200 mm. The cutting depth is 60 mm. The range of applications for a HOLZ-HER wall saw can be extended as required with genuine HOLZ-HER accessories.



The SECTOR 1255 allows one-man operation from panel storage to a finished, precisely cut section. It is available in highly varying frame versions with cutting lengths of 4,300 mm to 6,300 mm and cutting heights of 1,900 to 2,200 mm. The cutting depth is 60 mm. Special lengths up to 8,300 mm are available upon request.



The SECTOR 1257: This upright panel saw allows one-man operation from panel storage to finished, precisely cut section and is appreciated for its easy moving, ergonomic design. This panel saw features a powerful 5.5 kW motor and saw blade with a diameter of 303 mm. A speed-regulated motor with peak power of up to 9 kW is also available as an option.



The SECTOR 1260 automatic vertical panel saw is fully automatic for maximum cutting quantity and easy operation. Perfect ergonomic design, absolute precision and angular accuracy are the convincing features of the SECTOR 1260 vertical panel cutting saws. This upright panel saw allows one-man operation from panel storage to finished, precisely cut section.

Beam Saws

The HOLZ-HER LINEA 6015 pressure beam saw sets new standards in the economy class with the most powerful saw motors in their class, rapid setup times for prescoring saw and gentle, scratch-free panel handling. To ensure the perfect quality of your cutting work, the LINEA 6015 provides everything as standard features, such as air cushions on the support and machine table or the prescoring unit with 2.2 kW of power.



Thanks to its high acceleration values and feed rates, the TECTRA 6120 power can process even large quantities of panels rationally. This versatile saw is available with various cutting lengths and cutting widths, allowing it to be adapted to highly varying applications as a custom solution.



The TECTRA 6120 dynamic pressure beam saw from HOLZ-HER comes completely prepared for dynamic charging. It is distinguished by its absolute cutting precision and comprehensive basic features. Simple linkage to automated panel storage facilities as well as uncomplicated data transfer from conventional branch software or software from other suppliers is a further highlight of the TECTRA 6120 dynamic.



The ZENTREX 6215 lift horizontal panel saw demonstrates the highly stable machine construction you expect from HOLZ-HER. Infinite keyway and saw blade protrusion up to 115 mm and fixed main motor with power up to 21 kW qualify this machine to take its place in industrial production as well as craft shops alike.





Panel Storage Systems: Open Up Completely New Methods of Innovative Storage

With HOLZ-HER panel storage systems, increase the capacity and profitability of your shop. The personnel and organizational expenses for handling the panels is reduced to a minimum, even for a wide variety of panels and decorative finishes. The HOLZ-HER STORE-MASTER panel storage system is suitable for a variety of formats and materials.

The panels can be positioned by the manipulator in a chaotic as well as assorted structure. In each case, exactly the right panel is selected by a computer during removal. Your stock panels can be rotated easily by up to 90° and therefore stored in any desired direction. Damage to the panels is ruled out due to automatic, computer-controlled transport.

Storage solution (1) with precision pressure beam saw. The entry version for craftsmen, this panel storage solution from HOLZ-HER for charging a TECTRA 6120 pressure beam saw, offers ideal stockkeeping and perfect cutting for your craftsmen and a significant increase in productivity. The TECTRA 6120 horizontal panel saw can process even large quantities of panels rationally.



Storage solutions (2) with saw and nesting feature. Panel storage solutions for charging a TECTRA 6120 pressure beam saw and DYNESTIC 7532/7535 nesting CNC machining center in combination with highly efficient utilization of all available storage space. You can automate your custom production with the support of intelligent software.



Storage solution (3) professional cutting center. Panel storage solutions for your cutting center with the TECTRA 6120 and ZENTREX 6220 pressure beam saws for maximum flexibility in the field of panel cutting. The panel cutting saws from HOLZ-HER combine precision technology with intelligent handling solutions for effective and precise panel cutting.

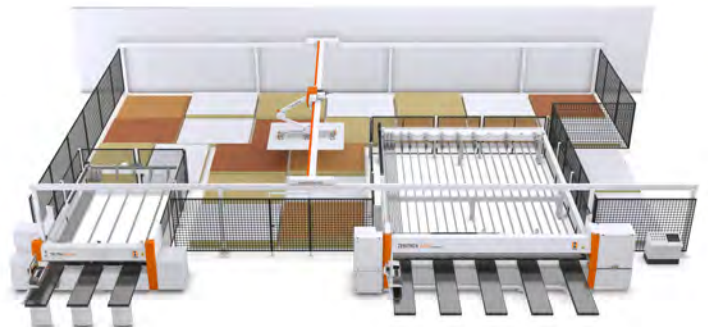

Storage solution (4) maximum output with saw and nesting feature. The ZENTREX 6220 pressure beam saw with its high series cutting capacity is connected to the DYNESTIC 7532/7535 CNC machining center for custom job production in the nesting field with possibilities for milling, drilling, and sawing. These high-end nesting and sawing solutions from HOLZ-HER combine individuality and flexibility with maximum output.

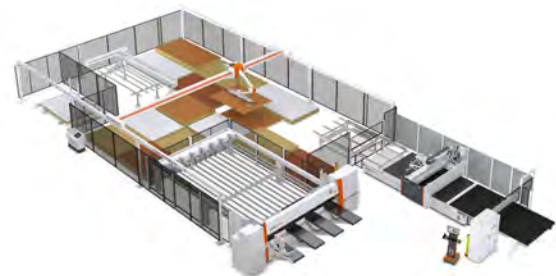

LEARN MORE



SHODA

SHODA Embodies the Best in CNC Routers

SHODA continues to evolve into a global brand with world-class CNC technology.

Every SHODA product is hand-crafted and assembled, one by one in their clean and modernized factory located in Japan. With over 90 years of history since their founding in 1926, SHODA has produced more than 8,000 CNC routers to customers all over the world.

Each of the machine's components is precisely examined utilizing a three-dimensional Coordinate Measuring Machine to ensure comprehensive quality control. With a commitment to total perfection and complete customer satisfaction, SHODA's experience can be seen in each machine. That knowledge, experience, and craftsmanship will assure customers that with SHODA they will achieve successful results with each of their high-quality CNC routers.

SHODA CNC Routers

Standard Gantry Type CNC Router NCN1210:

The built-in spindle, developed by SHODA, delivers both high power and high speed. The NCN1210 includes a high-speed spindle up to 20,000 RPM. Its environment-friendly design offers optional double dust collectors around the head. SHODA's CNC Router NCN1210 offers an angle head with C-axis as an option.



SHODA NC260 compact two-head CNC Router:

Its compact design allows high precision three-axis machining in a space-saving design. A great solution for heavy machining loads on smaller parts. The NC260 offers a built-in AC spindle with up to 20,000 RPM. Head spacing can be changed automatically (One head model is available).



SHODA Basic NC router NC2001's stable cutting surface is realized by using many cast parts as vibration countermeasures. Its strong rigidity and optimized servo adjustment realize high-precision and high-speed machining. Its unique dust collection mechanism provides high chip collection capacity. Finally, the head is equipped with a self-developed high-performance spindle with stable torque, ideal for precision machining and up to 18,000 RPM.



SHODA

Superior • High-Quality • Original • Durable • Accurate



LEARN MORE



Barbaric Stands for Quality

Barbaric GmbH was founded in 1995 by Stefan Barbaric and has been the first point of contact for sophisticated handling technology ever since. Their ultimate goal is to support customers through custom-made handling solutions for wood and glass. Through years of innovation and the use of state-of-the-art components, Barbaric is able to implement ergonomic systems with high profitability and short payback periods.

Barbaric's automatic handling solutions take over fully automated process steps in plate and part production. Panel storage, feeding systems, buffer storage, and return systems are just a few examples of modern systems in the field of material handling. Each plant in this area is built individually according to the requirements of our customers while existing components and proven concepts are used.



Jib & Vacuum Lifter

With its 90 ° tilting function, the uniWood UWL 3 is versatile in the field of wood production, as boards can be manipulated both upright and horizontal. The lifter also impresses with its light, slim design and particularly easy operation. In addition to most commonly used coated wood materials, the uniWood UWL 3 is also ideal for handling air-permeable panels (OSB, chipboard, MDF over 8 mm thickness) and materials with a slightly textured surface.



The Barbaric SSK Pillar Jib Crane consists of a pillar with a base plate including an adhesive anchor, smooth-running jib, sliding trolley, main crane switch, power supply, fastening and connecting parts. A suitable concrete floor is a prerequisite for fastening with heavy-duty anchors. In addition to a wide range of standard construction heights and bracket lengths, other individual configurations are also available. The brackets are available in steel or aluminum.

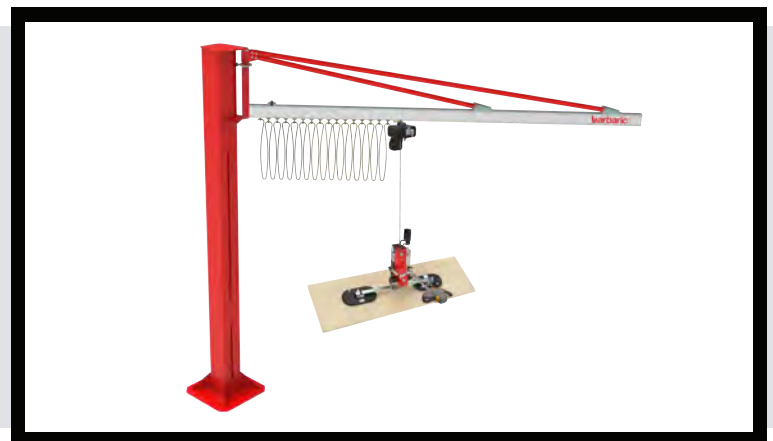

Panel Storage System CSF Professional

Barbaric's storage systems enable automatic storage of panel material with maximum efficiency and also allow fully automatic loading of various production lines such as saws or CNCs. From low-cost, compact solutions for production to high-performance industrial solutions as well as multi-level configurations - Barbaric offers a solution for every handling task.

Features

Barbaric is a specialist in warehouse logistics and vacuum technology. **The panel storage system CSF Professional** combines functionality, performance and design in one machine.

CAD-optimized product design and low net weights meet the high demands of fast speed and short cycle times.

For each company in the crafts, supplying or industry, Barbaric offers suitable storage solutions.

Individual Design for Each Customer

Each Barbaric panel storage system is adapted to the specific customer requirements. Barbaric develops the ideal concept in close cooperation with our customers. This results in ergonomic solutions for internal logistics.

Unique design and narrow body. All essential functions and components are integrated. Touch screen and user control panel can be placed anywhere around the storage system.

Control and Operation

Various storage configurations can be realized with our standard software.

- Integrated service tool for remote maintenance
- Simple, touch-enabled surface
- Windows-based application
- Extensive error analysis, with optional camera tool
- Integrated warehouse management and inventory management
- XY-alignment functions for the alignment of parts on machine stoppers

The Suction Traverse

Functionality even in little details. Modern, decentralized control modules and valve terminals create an easy and compact structure.

Energy-saving ejectors ensure economical and quiet operation.

- Automatic length adjustment
- Panel measurement
- Weight measurement
- MDF- and thin panel package
- Maintenance-free
- Power saving function

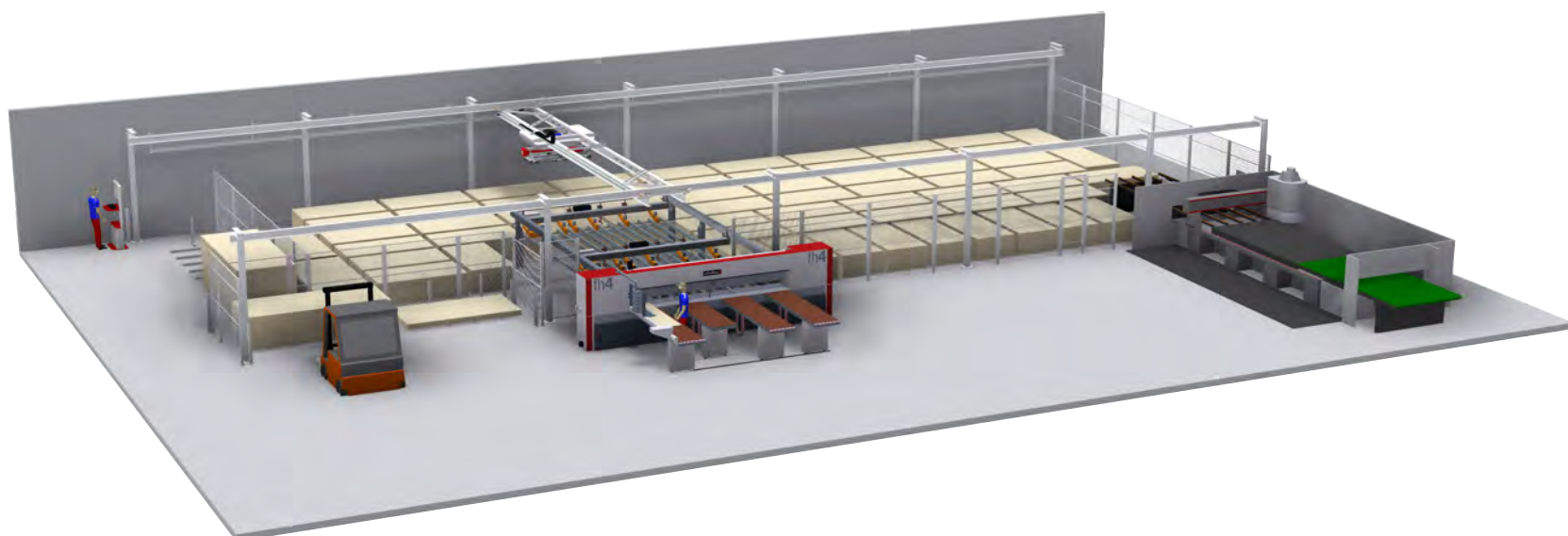

Maximum Efficiency and Fully Automatic Loading

With the 90° rotation unit, Barbaric's Panel Storage System CSF Professional allows for panels to be stored in all directions. In each stacking process the panels are measured and weighed. High process reliability through continuous measuring and recording of the weight of the panels. Orientation of the angular position while driving. 180° rotation unit optional.



Your Benefits At A Glance

- Optimized material flow
- Gentle manipulation; no damage of the panels during transport
- Optimization of space
- Reduced personnel expenses
- Simplification and alleviation of production processes
- Higher capacity utilization of your manufacturing machine
- Highest flexibility in production processes
- Best possible material utilization due to re-integration of rest pieces
- Integrated warehouse management
- Short payback periods of one to two years
- Order-picking - operation without saw is possible

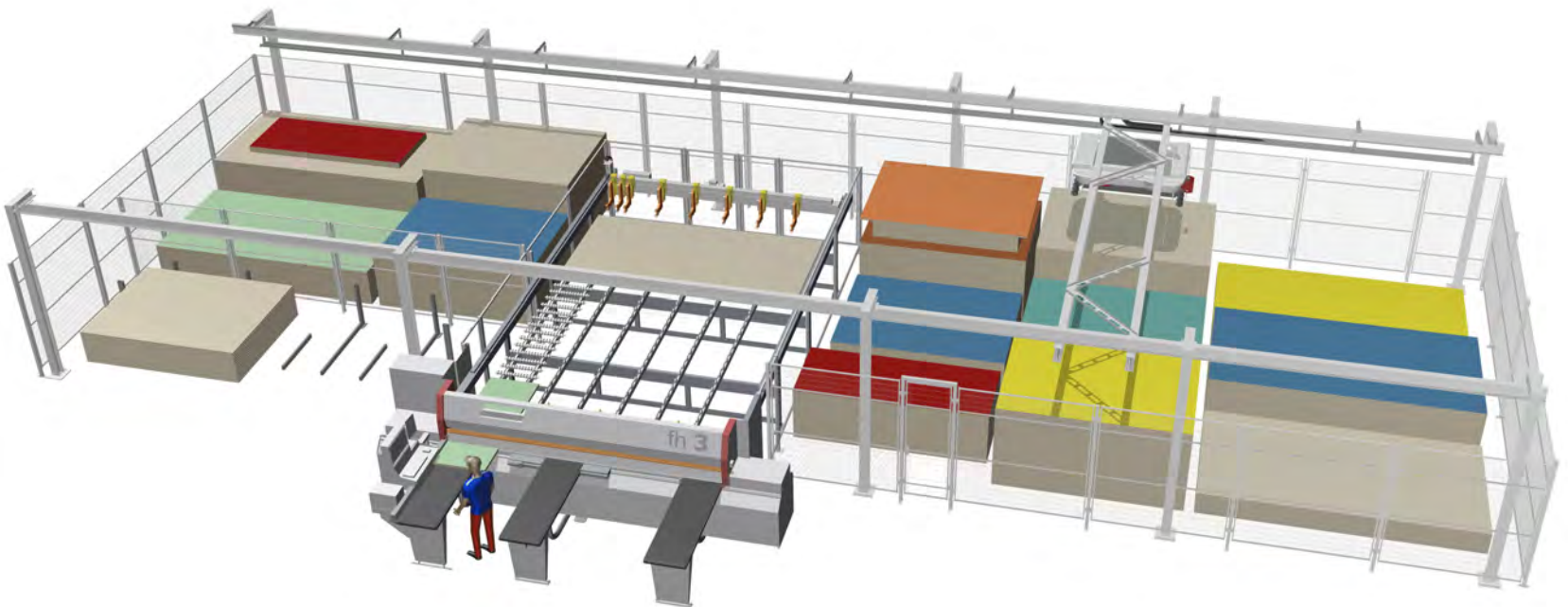



★ imos AG develops and sells software solutions for companies that individually design and plan furniture and furnishing elements, **including commercial casework and kitchens**, and produce them automatically and market them directly. Users enjoy full flexibility and a wide range of options when designing furniture: from standardized catalog furniture to individual contract furniture, they can realize all their ideas with iX CAD. Individual pieces of furniture or entire room situations can be constructed and presented impressively in a very short time.

SALES CONTACT:

Bryan Hynicka
 Vice President of Sales
 814-999-4516
 bryan@coffeymachinery.com

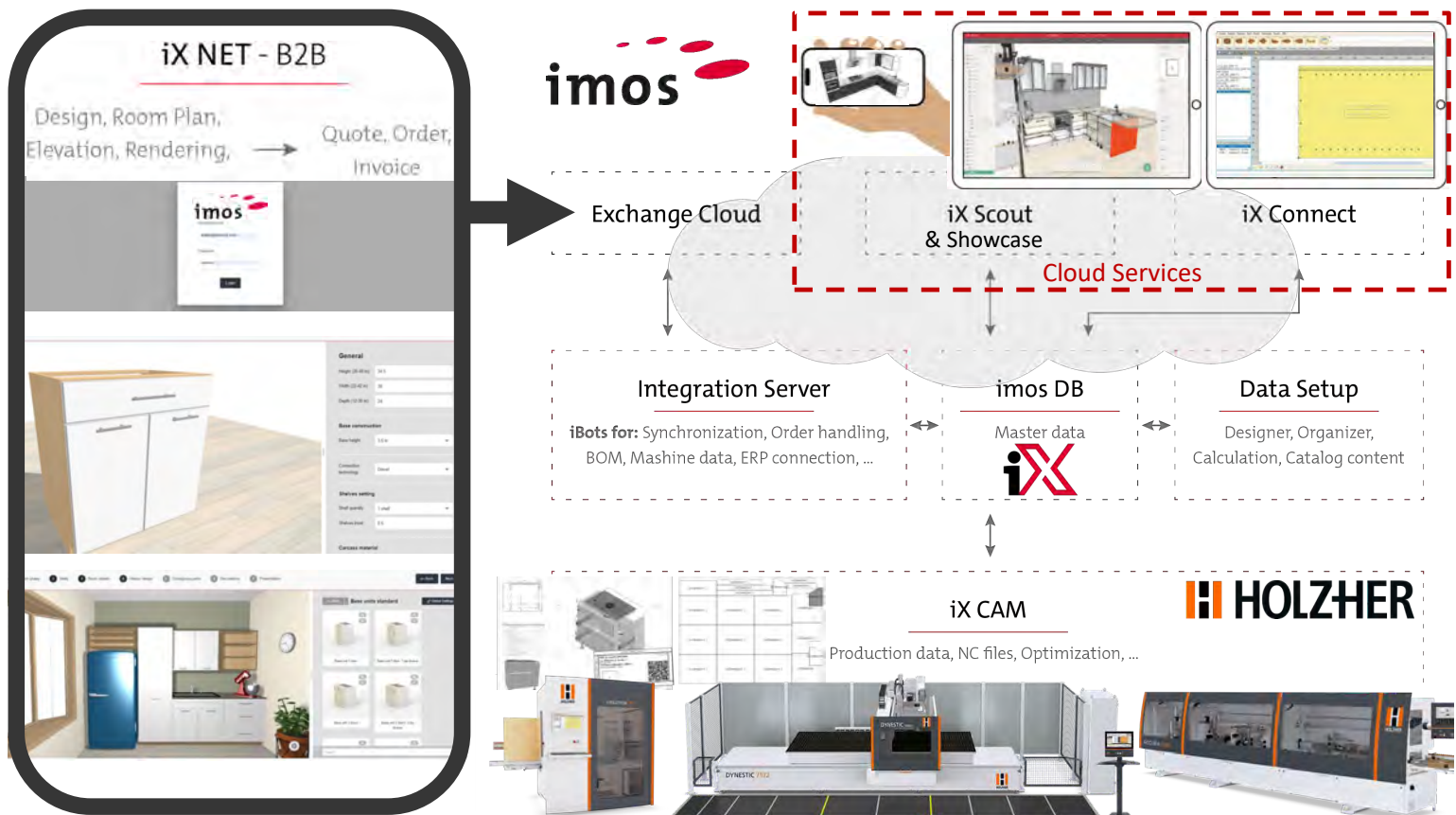



Kitchen
and bathroom
cabinetry



Architectural
Millwork



Case
Goods



Closets
and
Storage



Interior
Trims

shop automation software for the wood industry

CONNECT, OPTIMIZE, TRACK,
SYNCHRONIZE & CONTROL
YOUR PRODUCTION ACTIVITIES



SALES CONTACT:

Bryan Hynicka
Vice President of Sales
814-999-4516
bryan@coffeymachinery.com

LEARN MORE



**BRING YOUR
FACTORY TO THE
NEXT LEVEL**

web-cab.com

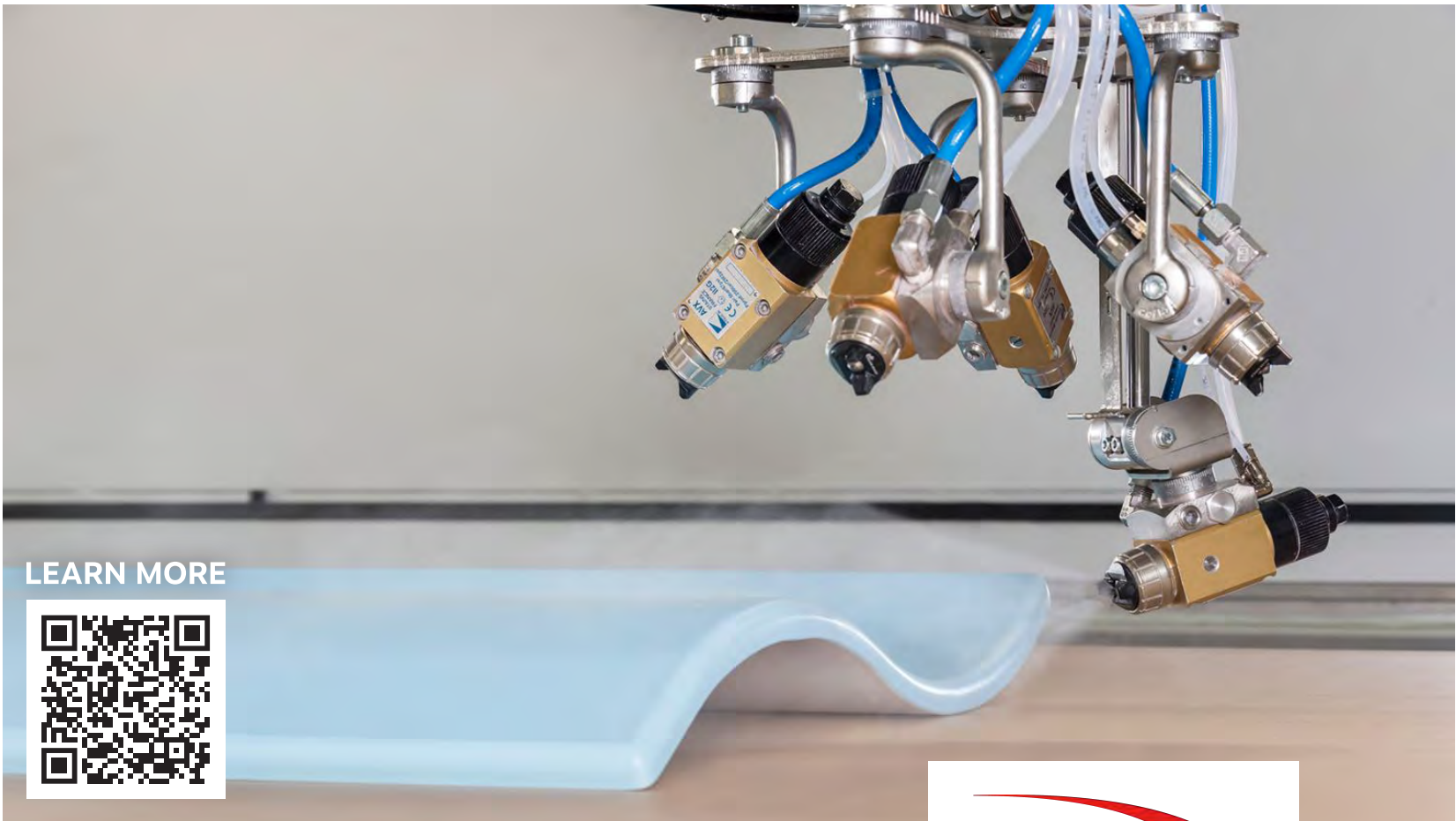

LEARN MORE



Finishing Systems for All Substrates

Cefla is the world leader in finishing solutions, offering a full complement of spraying, drying, roll coating, vacuum coating, curtain coating, and profile sanding machinery. Cefla’s technology operates with water, solvent, and UV coating formats. Cefla offers stand-alone equipment or completely engineered systems and operates a 15,000 sq. ft. state-of-the-art testing laboratory in Charlotte, NC.

Cefla offers the broadest range of finishing and coatings application equipment on the market. With Cefla, you can find solutions to coat virtually any substrate: wood, metal, glass, plastics, and composites. Let Coffey Machinery consult with you about how Cefla may help improve your process.

Coffey Machinery proudly represents Cefla, the forefront leader in finishing solutions. Immerse yourself in a comprehensive array of finishing machinery, including Vacuum Coaters, Spraying Systems, Drying Systems, Brushing Machines, and Complete Finishing Lines. Cefla's technology is versatile, operating with water, solvent, and UV coating formats. Whether you're working with wood, metal, glass, plastics, or composites, Cefla offers a solution to meet your needs.

CEFLA Products

Vacuum Coaters

Spraying Systems

Drying Systems

Brushing Machines

Finishing Lines

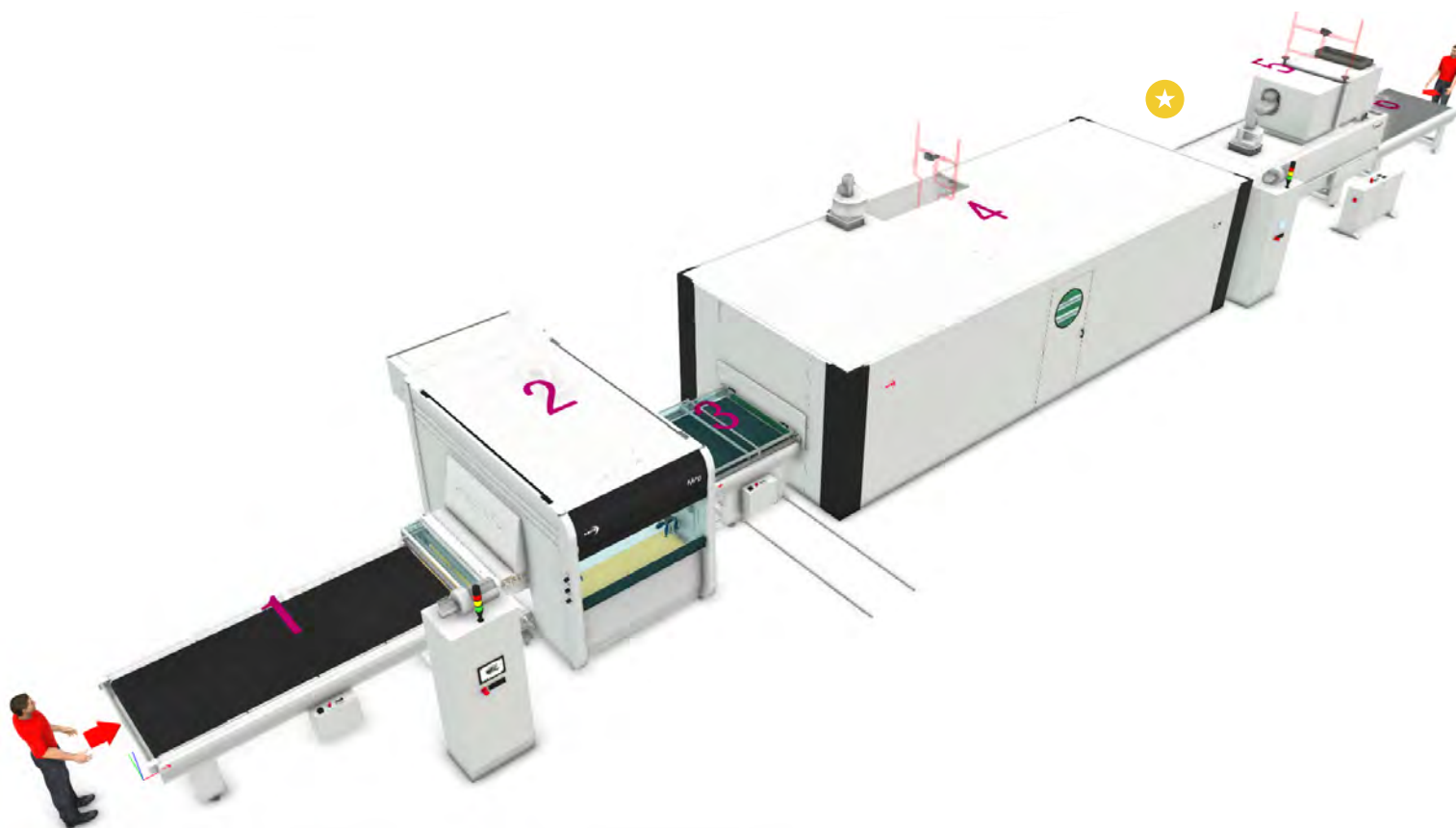

CEFLA: Vacuum Coaters & Spraying Systems

These solutions finish up to four sides in a single pass with an all-in-one footprint with sanding, brushing, wiping, and curing. Furthermore, these machines are designed, engineered, and built in the U.S.

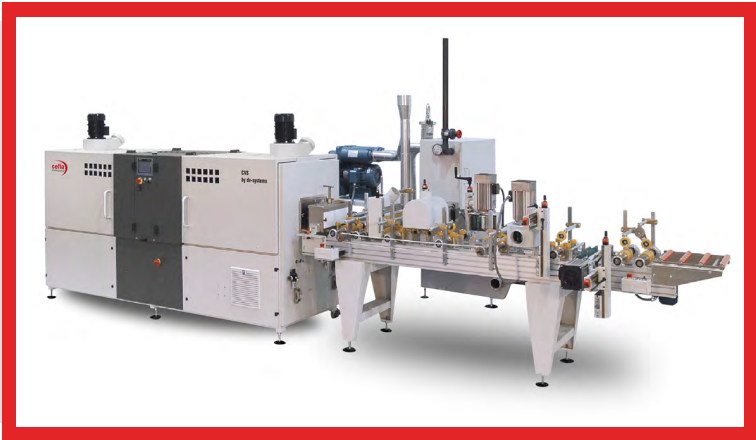

Cefla's CVS Vacuum Technology: Designed for mouldings, profiles, and flooring using 100% solid UV coatings. Meet the needs of any coating formulation to match color, sheen, abrasion, and chemical resistance. The process provides total control of the cure temperature, making it ideal for heat sensitive substrates and/or applications. The CVS is the only moulding finishing system for UV that incorporates Sanding, Coating and Curing in a single system.



Cefla's CVR Vacuum Technology: Designed for mouldings, profiles, and flooring using water-based coatings. This finishing system integrates sanding, coating and drying in one single and easy to use machine. A vacuum unit applies water-based stain or primer uniformly onto any profile or shape to produce a consistent and uniform coloring. This vacuum process enhances grain definition without the need for brush or hand wiping.

Spraying Systems

PRIMA by Cefla is a one-armed reciprocating spray machine. This machine is ideal for companies seeking cost-effectiveness, excellent flexibility, and productivity. Prima is user-friendly and reliable, with low operating costs and initial investment. Perfect for graduating from manual to automated finishing with small production batches. PRIMA can be used as a stand-alone unit, tended by one or two workers who load or unload workpieces by hand.



PRIMA EVO is a one or two-arm reciprocating spray machine suitable for water or solvent-based applications and even glue. It is ideal for small to medium-sized companies that are looking for productivity as well as cost-effectiveness.



EASY is the easy-to-use two-arm reciprocating spray machine developed to provide the highest quality finishes. Designed to meet high-volume production needs with the optional FCS (Fast Color Switch) developed for a zero-time lost production where the color change happens while the conveyor never stops in between charges.



IBOTIC is the interpolated axis Cartesian spraying robot with one or two arms. Perfect for high production capacities and unbeatable quality, with a reading barrier designed to read 3D parts and an optional TIMESKIP for color changeover with no downtime. IBOTIC can work simultaneously on pieces of different shape and thickness, with the conveyor either at standstill or on the move, in tracking mode. Also available for glue applications.



Full Affordable Finishing Lines By Cefla

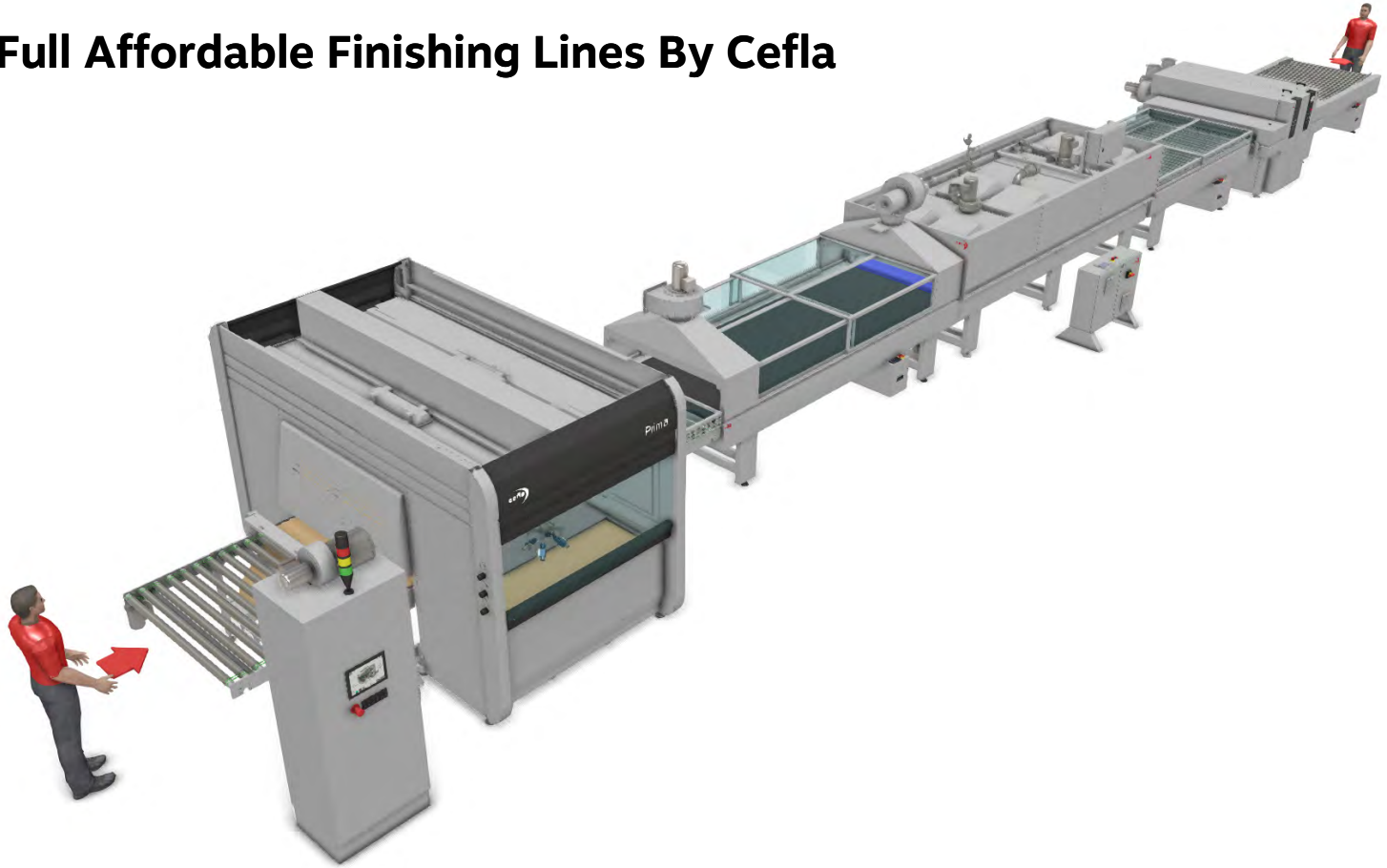

New Technology!



The UNIDRY-G is a flatline, gas-powered drying system that expedites the drying of water and solvent-based coatings. Its compact size accommodates shops with space limitations. Built in the USA, the Unidry-G has a minimal volume of emissions when compared to alternative drying methods. This drying solution has revolutionized the finishing industry and is unique to Cefla North America.



The Cefla PSP6 is a lineal spray line for moldings, S4S, and flat pieces in a feedthrough design. Various drying solutions after this machine are possible. Equipped with up to six spray guns on one or two circuits, the system also has a roller and belt conveyor system to quickly move parts through the spray booth. Perfect for small batches.

The Industry's Newest Technology

Whether utilizing stand-alone machines or complete production lines, Cefla has the perfect solution, custom for your facility. With an advanced production line from Cefla, flexibility and efficiency come together to achieve a real competitive advantage.

Smartclean is a comprehensive range of brushing machines for all cleaning requirements associated with various substrates. Suitable for flat and shaped, rough and smooth panels, after primer application, and before finishing. Smartclean has the capacity to process multiple panels and manage small-sized panels, and its brushes do not require cleaning at the end of the day.



The Pieffe delivers the functions of an in-line oven 45 meters long within just 10 meters, thanks to a stacked tray system. This oven is essential for obtaining curing times suitable for water, solvent, and UV paints and high-speed hot-air drying cycles for special paints or drying glue upstream of membrane presses. Drying times can be regulated depending on the type of paint / glue used or the type of process.

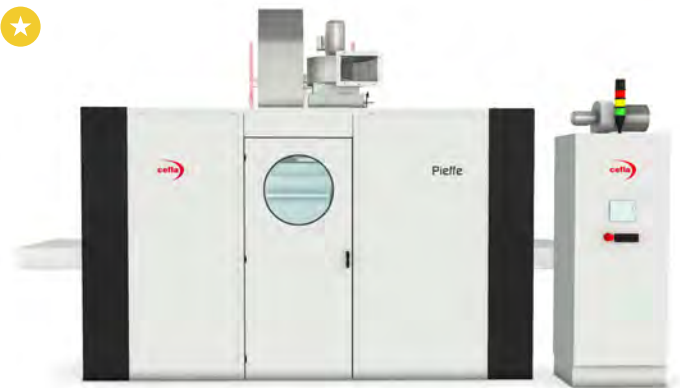

OMNIDRY is the final frontier in vertical oven design. Its construction characteristics support OMNIDRY's state-of-the-art performance and reliability. The optional FLEXPLO function can automatically manage variations in passage height in response to piece height. OMNIDRY offers extreme modularity, giving you the option to expand with an additional 2, 3 or 4 sections.



FAST CATALYTIC PAINT DRYING SYSTEM

LEARN MORE



Not just fast... SPOT-ON!

The logo for Sun-Spot, featuring the word "SUN-" in a bold, red, sans-serif font, followed by "Spot" in a black, cursive script font.

Sun-Spot Catalytic Flameless Combustion

The catalytic heater is a type of heater that emits infrared heat without using any flame. This results in heat in the form of medium to long infrared waves. This output is evenly absorbed by a wide range of organic materials such as wood, plastic, and metal.

Sun-Spot's products are flameless catalytic infrared heaters. The HT-100 and HT-200 are cost effective and can force the drying or curing of any type of coating. Sun-Spot's flameless catalytic heaters produce extraordinary results. They are up to 80% more economical and 4x faster compared to hot air convection drying. Catalytic flameless combustion is 100% safe to use and a tested process.

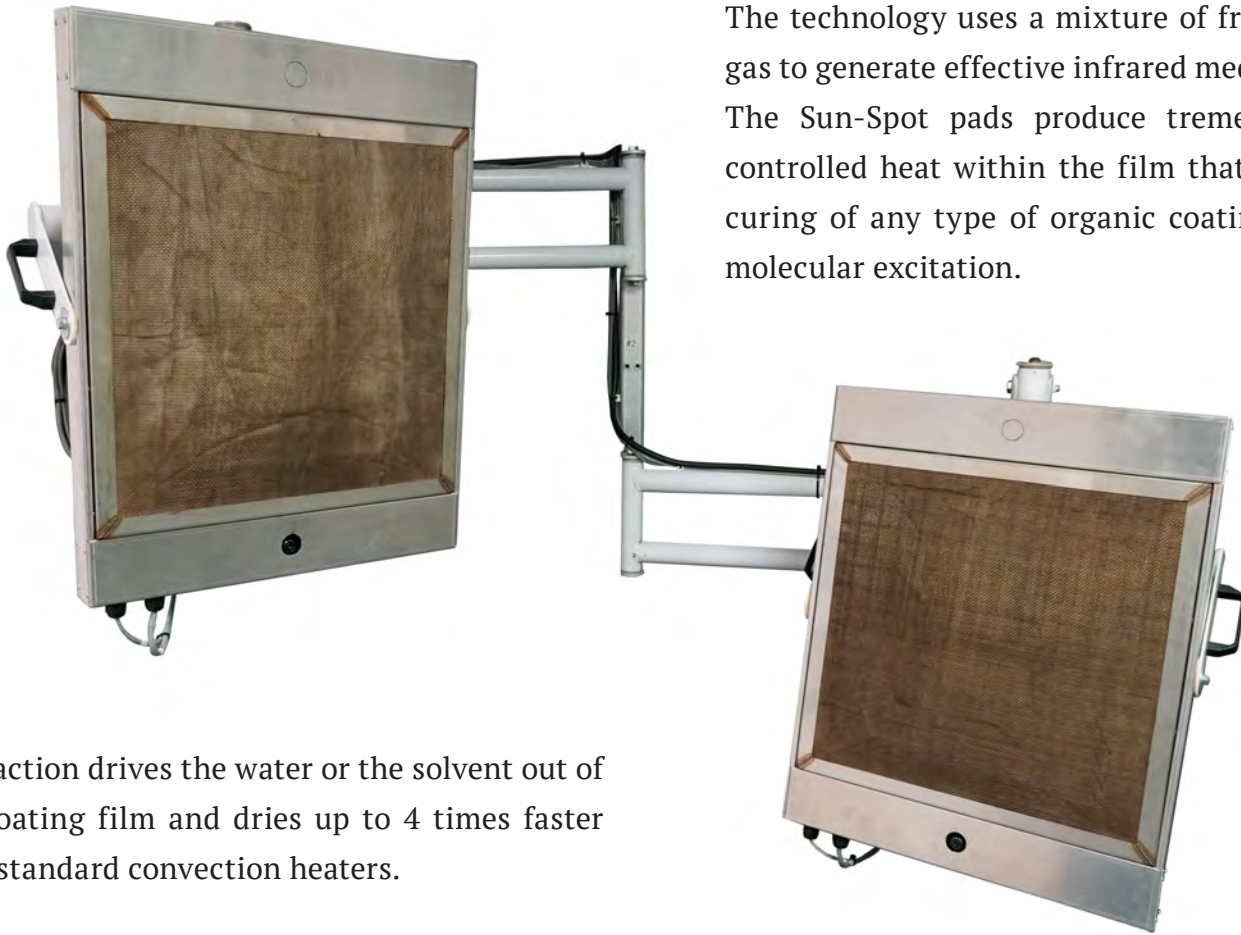

The technology uses a mixture of fresh air and gas to generate effective infrared medium waves. The Sun-Spot pads produce tremendous but controlled heat within the film that forces the curing of any type of organic coating through molecular excitation.

This action drives the water or the solvent out of the coating film and dries up to 4 times faster than standard convection heaters.

The **Sun-Spot HT-100** is their standard model which offers a wide array of features. Built to last, performance paint curing at its best.

- CSA international approved
- Flameless, catalytic combustion, 100 % safe
- Very fast curing, low fuel consumption (less than .75\$ per hour)
- Energy saving: 70-80 % compare to convection

The **Sun-Spot HT-200** Catalytic Heater is a premium unit that delivers twice the curing surface. With outstanding results, the Sun-Spot HT-200 delivers the efficiency you've been looking for!

- Curing foot print 4 X 4 feet by heating head
- HT-200 (2 heads) have a 4 X 8 feet foot print
- Infrared medium waves
- 6 to 8 times faster than convection





LEARN MORE



Bond | Protect | Beautify: Your Solution for Your Finishing Needs

SAMES KREMLIN provides industrial solutions for production increase, quality improvement, and material and cost savings.

SAMES KREMLIN offers a wide range of products designed for liquid paint that provides a comprehensive solution for all your finishing needs, from pumping systems to sprayers to fluid handling, dosing, mixing, and dispensing.

With over 98 years of innovation in applying paints, adhesives, and sealants on all surfaces, SAMES KREMLIN is a leader in industrial automation.

Spraying Solutions

The automatic Airmix® AVX spray gun ensures high level performance with unsurpassed finish & excellent atomization quality. The base-mounted modular design allows for quick maintenance with minimum downtimes. It is lightweight and versatile for efficient production. Expect a high transfer efficiency up to 86% and excellent atomization quality.

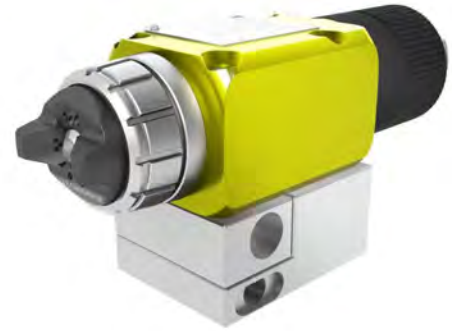

The 20C50 Airmix® pump is a medium-range, all purpose pump for medium viscosity products. Special model 20C50GT for water based and high solid content. The 20C50 Airmix® pump is available with a suction rod or gravity hopper, heavy duty air changeover valves and good chemical compatibility with GT, Chevron, and PE seals.



The 10C50 GT Airmix® Paint Pump is the perfect pump for Airmix® applications by providing exceptional performance. Recommended for one or two Airmix® gun operations. This high efficiency pump excels at maximum energy savings. Handles one component or two component solvent or water-based materials, high solids, varnishes, lacquers, polyurethanes, stains, epoxy, single or two-component adhesives.



The Cyclomix® Evo modular dosing unit can be used with solvent or water-based paint, acid catalyst, PU or epoxy materials. It brings you: Perfect dosing and mixing, high productivity, optimized waste management, and full connectivity. Thanks to its new patented injection method, the Spraymix technology allows a pre-mixing at the injection point. Spraying the catalyst into a vortex of base ensures a perfect mix and a ready-to-apply paint.

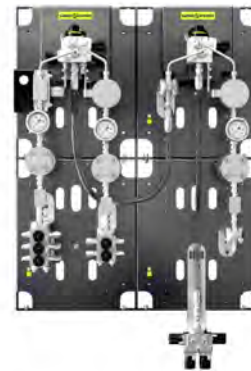

Sanding Solutions Offered By Coffey Machinery

Coffey Machinery represents the best sanding brands in the business that offer incredible commercial sanding machines, suited for a variety of woodworking applications.

KUNDIG

LEARN MORE





Kündig Technic

With the Technic series, almost everything is possible. These machines are extremely customizable, allowing Kündig to offer solutions for virtually any sanding application by utilizing Kündig's proven portfolio of technologies that include: oblique sanding for a defect free finish, high-precision solutions for tolerances (.0004"/.01 mm), line integrated industrial systems, and the processing of special materials such as composites, plastics, and many more. Thanks to three quarters of a century of experience and Kündig's modular machine design, we can offer configurations engineered for your specific requirement. Kündig is also known for developing new sanding technologies either working in close cooperation with the customer or in their extensive R&D Lab where Kündig strives to remain at the cutting edge of the industry.

With the KUNDIG Technic-Perform-6, extremely specific machining is possible for practically every conceivable application. You can rely on a large number of intelligent automatic mechanisms, or experiment yourself with the help of our intuitive control system. For cleaning workpieces and sanding belts, the innovative Eco Cleaning System is used, which completely eliminates the need for expensive compressed air.

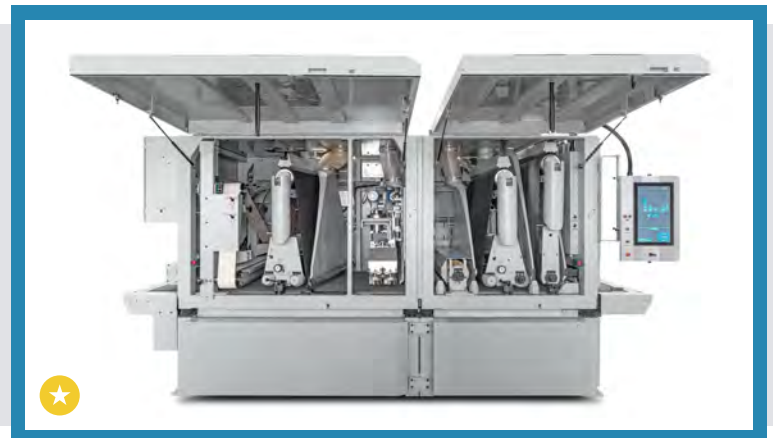



★ Kündig UniQ Series / Kündig Flash

Kündig's industry leading edge sanders are extremely versatile, offer the highest sanding quality, and their solid construction ensures decades of reliability. All models feature the 45 degree pivoting sanding unit, which oscillates with a stroke of 3.5 inches. Maximum oscillation range is a whopping 90 mm/3.5". Thanks to the flexible adjustment and the large oscillation range, sanding belts can be used optimally over their entire width, without any tedious adjustment of the working table height. In addition to the features of our UniQ edge sander series, the UniQ-S model has a feed unit integrated into the machine body and is therefore ideally suited for the efficient throughfeed sanding of small and large production batches. The Flash model also has this feed system but is designed for sanding sealer, primer, and lacquer edges. With its features which even allow for sanding of high-gloss lacquered edges, the Flash is unique among edge sanders.

Kündig Master

Kündig's Master series wide belt sander combines all the features that are essential for fast, and reliable sanding to a perfect surface quality. High production of these standard configuration wide belt sanders deliver Kündig engineered quality, great sanding performance, and maximum durability at an affordable price. The 2 sanding units guarantee absolutely perfect and precise calibration and high quality finishing of solid wooden and veneered workpieces (veneer thickness has to be greater than 0.8 mm [0.031"]). The amount of contact rollers determines the stock removal you can achieve in one sanding pass. The MASTER series combines over 75 years of building top class sanders, market experience, and an innovative, reliable sanding solution for the demanding industry.





LEARN MORE



STOLBEK

Because Sanding Sucks!

STOLBEK presents cutting-edge sanding solutions aimed at enhancing quality, productivity, and profitability within your business. From groundbreaking robotic sanding solutions to the innovative pneumatic spray assist spin bot, STOLBEK's products are tailored to streamline operator tasks and elevate your company's bottom line.



Experience uninterrupted painting sessions with the Spin Bot! This innovative tool rotates your products seamlessly, eliminating the need to pause and adjust manually. Operating solely on pneumatic power, the Spin Bot removes electricity from your spray booth. Its cushion and rotation speed are fully adjustable, while its wheels ensure effortless maneuverability within your workspace.

STOLBEK's "Ultimate Edge Sander" streamlines 7 steps into one, sanding a door in just 30 seconds! Its variable speed belt and PLC Controller offer precise control. Featuring 5" orbital sanding heads with 3 grit progressions and 2" orbital corner break sanding heads, the sander allows quick, efficient change out of its incredibly long-lasting abrasives.



Cosmo SC2448-2: Your complete robotic sanding solution! Equipped with a heavy-duty, world-class Yaskawa industrial robotic arm and cartesian slide table. Sand a door in minutes with less labor! Sand recessed, raised panel and slab doors **without** sanding through primer! End of arm tools include a 5" orbital disc, 3"x 5" orbital pad, and 2" pad for corner breaks and edge sanding. No coding, programming, or bar code scanning required!



Do you need a larger sanding solution to handle your workload? Meet the Cosmo XL: the next level up from the Cosmo SC2448-2! The Cosmo XL is a robotic sander that features all of the automation you will find in the Cosmo SC2448-2, while also including an extra large work envelope, extra large touch screen display, and the ability to flip your parts mid-cycle and seamlessly unload them for unparalleled automation.

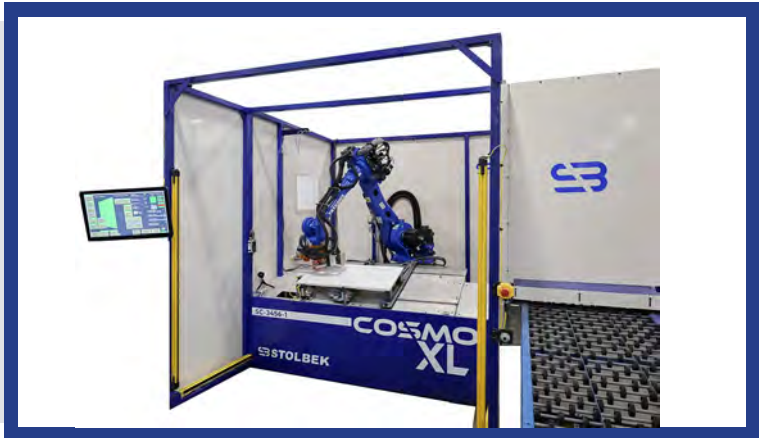

Built for king size jobs, the Cosmo Slide can sand parts twice as wide and 2.5x as long as the standard Cosmo! Utilize its incredible 48" x 120" work envelop for maximum reach and versatile part sanding. Achieve consistent finishes with precise control over pressure, speed, and cycle repetition. This robot excels at sanding your longest panel, with all the benefits of the standard Cosmo. Enjoy sanding efficiency and reduced labor costs with the Cosmo Slide.

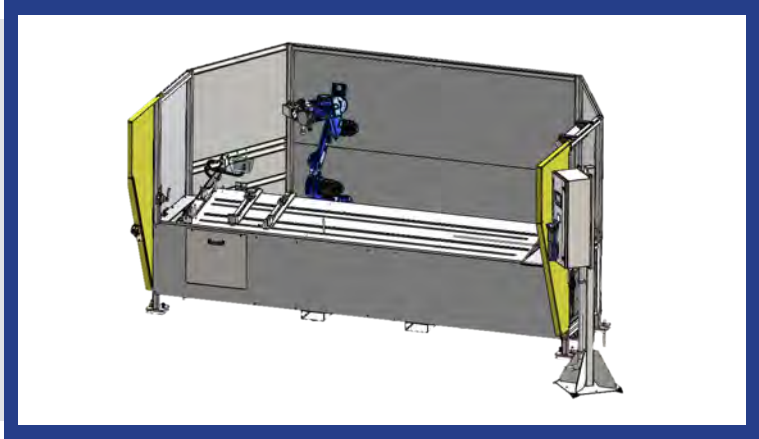



MB Maschinenbau: Sanding Machinery

MB Maschinenbau offers a wide range of machines that can handle your sanding jobs simply, inexpensively, and at a very high quality.

Raw wood or wood composites such as MDF, veneer, particle board, or plywood must be perfectly sanded at an early stage of production. Only in this case, all following finishing production steps by varnishing or laminating are under control. The MB machine range offers for each application the appropriate solution: wood sanding, sealer sanding and final sanding of all kinds of panel workpieces are, thanks to the MB modular machine design, feasible.

Of course, edge sanding is always needed to achieve perfect workpieces. For this application, MB offers machines to process work pieces manually or in a through-feed operation. Depending on budget and needed volumes MB is able to offer different solutions.

The ROBA REP edge sanding machine was developed for MDF, white wood, primer, and intermediate lacquer sanding of edges. The ROBA REP offers high throughput with a fully automated sanding process for edges. Its “no set-up” workflow allows you to load the machine without any consideration of part dimensions. The ROBA REP is an excellent addition to Joiner’s workshops, industrial plants, cabinet door producers, and door production shops.



The innovative ROBA Big is equipped with a newly developed, extra-large sanding brush diameter of 630 mm. This makes it possible to expand the contact area with the workpiece to approx. 300 mm. The increased number of slots allows more than 500 meters of abrasive to be installed, depending on the machine configuration.



The ROBA Bottom Sander machine line is constructed for bottom sanding of work pieces in a through feed process for applications including intermediate lacquer sanding, white wood sanding, and MDF sanding. The ROBA Bottom Sander is the perfect complement to all top working MB surface sanding machines.



The starting point of the ROBA Profi-Brush principle is clockwise followed by counterclockwise direction sanding. Only this procedure guarantees that in every case, protruding wood fibers are cut off, regardless of the grain direction of the material, both wood or MDF. Its pressure roller system will hold work pieces from 370 mm safely.





LEARN MORE



Time Saving Solutions In Woodworking

Timesavers offers industry-leading grinding, sanding, and finishing solutions to enhance woodworking and metalworking production rates. Different wood species and product types require alternative processing techniques. You need a range of equipment if you want to achieve an optimal finish.

Timesavers offers an extensive line of commercial sanding machines and equipment suited for a variety of woodworking applications, including products for brush sanding, panel sanding, orbital sanding, heavy stock removal, veneer and lacquer sanding, wide belt sanding, and calibrating. Timesavers products are ideal for millwork, cabinetmaking, and furniture building. All are available in standard configurations or customized models adapted to accommodate your specific materials and production processes.

The Timesavers Speedsander is a versatile, entry-level sanding machine that uses a combination drum and platen head to improve the finish on wood, mitigate hand labor, and is a time and cost-saving upgrade over the entry-level drum sander. This portable model is designed for cabinetmakers and woodworkers and is ideal for a variety of woodworking projects.



Timesavers 23 Series: If you're looking for a durable and efficient tool to dimension and finish wood products with ease, look no further than the 23 Series stationary widebelt, planer, orbital, and veneer sanders. These dependable machines feature up to four heads, in many combinations for added versatility with 75" or 103" abrasive belt lengths.



The 33 Series machines are time-tested, with a workhorse design for maximum performance, and a competitive price to deliver outstanding value. With machine widths of 25, 37, 52, and 64 inches, the 33 Series is designed to impact a wide range of woodworking applications and situations, such as sanding, planing, orbital and veneer sanding.



The 53 series is a versatile powerhouse that features up to five heads in one machine frame and a maximum of 125 horsepower on the sanding heads. The 53 Series is a massive machine that utilizes heavy, durable components for a long life of heavy use. Ideal for large-scale widebelt sanding and calibrating, heavy stock removal, panel sanding, and veneer and lacquer sanding during 24/7 operations.





kardex

LEARN MORE



Automated Storage and Retrieval Systems

Kardex Remstar develops, produces, and maintains dynamic storage and retrieval systems. These systems provide excellent storage solutions by saving space, optimizing room height, and securing stored goods. With a Kardex storage system, your business will take advantage of more storage space/capacity in a smaller footprint, increased throughput, and improved inventory control.

The Vertical Lift Module **Kardex Shuttle** is a high-density storage system designed to meet a broad range of applications in several different industries including manufacturing, distribution, retail, and warehouse operations. The new **Kardex Megamat** is an automated carousel which rotates vertically around a track to bring stored inventory to an operator.

— Efficient and ergonomic storage and retrieval processes that will meet your storage needs.

The Kardex Shuttle is a Vertical Lift Module (VLM) that stores two columns of trays vertically on the front and rear of the machine. An extractor located in the middle of the VLM automatically moves trays to the access opening. Optiflex technology automatically measures the height of the stored goods on each tray and assigns them to an ideal storage location.

Thanks to its flexible and modular design, the Kardex Shuttle can be adapted at any time as product volumes and sizes change. It ensures a small footprint with space savings of up to 85% and dynamic storage space allocation.



The Kardex Megamat is a Vertical Carousel Module (VCM) that provides quick and precise access to stored goods. This future oriented system, based on the latest technologies, is built with a series of carriers attached in fixed locations to a chain drive. A motor powers the carriers to move in a vertical loop around a track in both forward and reverse directions.

The Kardex Megamat is especially suitable for frequently accessed goods because it conveys the right carrier to the access opening via the shortest possible path. It is the ideal choice when storing products with similar heights.





LEARN MORE



Clamping, Handling, and Transport Machinery FOR THE FURNITURE AND WOODWORKING INDUSTRY



Quality is first and foremost, from the initial concept to the finished product. While the industry has changed immensely over the years, there are some things that remain the same, such as our attention to detail, the quality of our products and our care for our customers. Explore the site and take a look at our machines. Dynma is a company made up of dedicated, technical personnel with a wealth of experience in the manufacturing of machines for clamping, handling and the transporting of furniture, semi-finished products and other products in the wood industry.

Dynma supports a wide range of clamps for the assembly of cabinets, drawers and frames. Additional equipment can be added to the clamps on an individual basis to ideally meet your needs for small or medium-sized production volumes. Regardless of the individual equipment of our clamps, each top-quality component demonstrates high reliability, absolute precision and robust, safe operation over long periods of time.

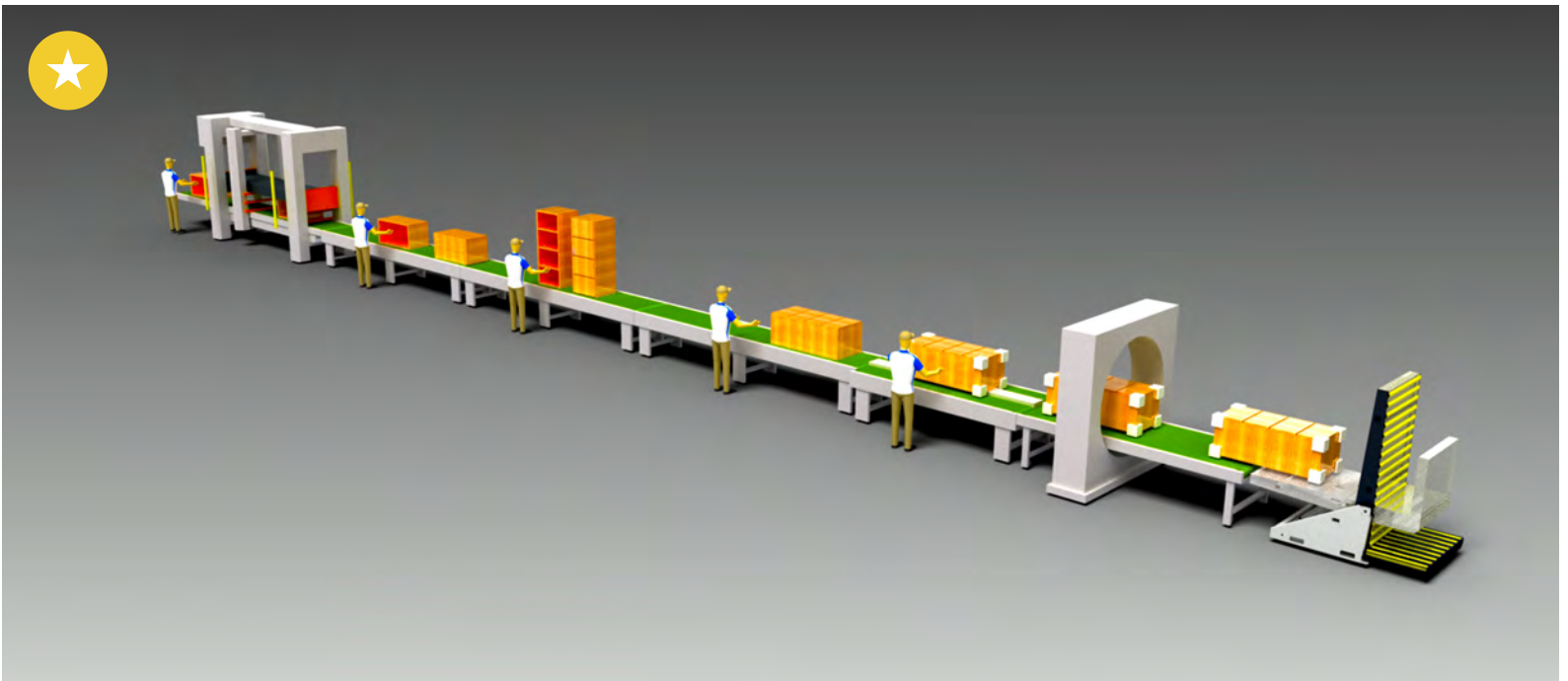

Handling, Transport, and Packaging Machinery

DYNMA is a specialist in developing customized solutions for the specific needs of each customer. Our team is specialized in 3D design, manufacturing, and machinery automation; so we can offer the development of integral solutions. From the manufacturing of the transport elements to the deployment and integration within the system. DYNMA puts at your disposal our technical department to design a tailored solution, according to their production needs and adapted to the space of its factory.

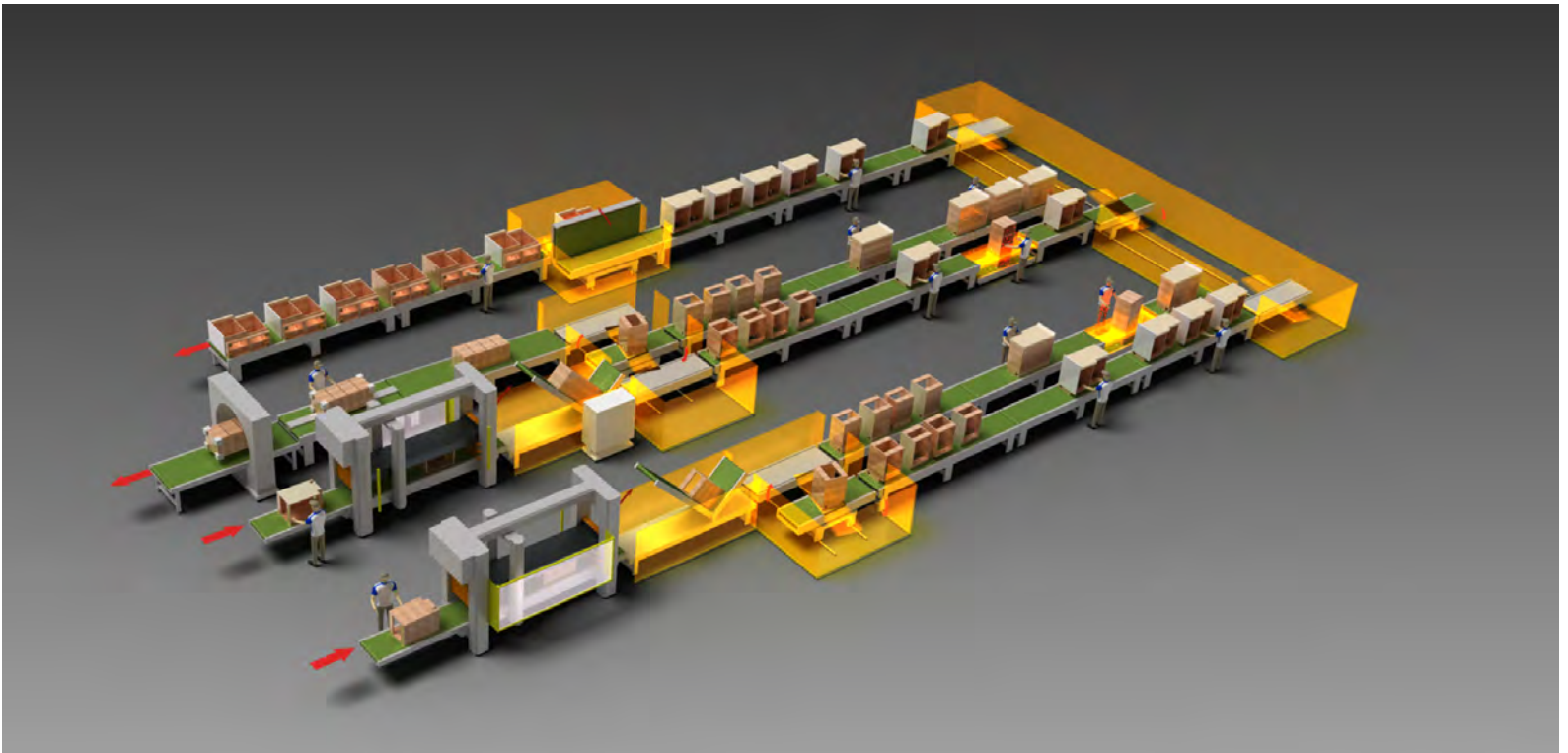

Clamping Solutions



The Dynma VK-015 is a modern through-feed electro-mechanical clamp designed to automate the assembly line of case goods and kitchen manufacturing. It allows for the fastest, most precise method of assembly utilizing the least amount of labor needed. With the ability to add many in line features to customize the line to your exact needs.



The Dynma Airkomp is a manually loading electro-pneumatic press suited for small to medium levels of production. Its powerful “Finger style” clamping beams distribute pneumatic pressing strength evenly over all surfaces of the components being clamped. The unique feature of this clamp is that the vertical beam (side pressure) is moved manually and can be locked in any required position. This makes adjustment quick and seemingly effortless.



The Dynma VK-011 is a manually loading, semi-automatic electro-mechanical clamp. Its strong clamping plates, which can generate up to 4,400lbs of pressure are electronically controlled. The VK-011 comes standard with an air table, conserving human energy and further preventing surface damage. The air table also means this clamp can be easily upgraded for integration into production lines.



The Automatic Transfer Station (ATS-2670) is a transport element that can convert the VK-011 into an integrated assembly line avoiding the manual handling of cabinets in the process of clamping. Located behind the press allowing cabinets to be unloaded and inserted in transport lines. Equipped with PVC-coated driven rollers and polyurethane cross-belts.

Clamping Solutions

The Dynma ADP is an electromechanical press designed for the precise clamping of doors and frames at high production rates. Able to clamp shaker & mitered doors, the clamp can be adjusted automatically, making it straightforward to assemble doors and frames of different dimensions and types of joints with ease, with clamping bridges and cylinders keeping the doors in position safely throughout the process.



The highly versatile Dynma BOX 3.0 is a totally pneumatic door & drawer frame assembly clamp. The different work modes allow for different clamping motions enabling it to assemble drawers and frames with any kind of joint (folding system, dovetail, dowels etc.) with perfect connection and squareness of the finished product, every time. Great for folding connections and drawer fronts with glass insets can be pressed without damage.

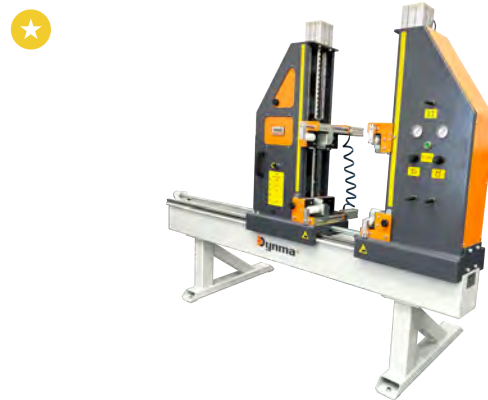

The Dynma BOX MTS is extremely effective with any type of joint, the movement and tightening by servomotors, with the use of linear guides ensures a perfect joint connection and squareness of the finished product. Managed via a simple but powerful touchscreen control with Ethernet connection it can be instantly programmed and pre-adjusted using a bar code reader. Programs can be written, saved, and retrieved quickly for fast set up.



The Dynma PR Plus is a fully electronic rotary clamp with servo-driven turning movement for the precise and fast pressing of interior and exterior doors in high production levels. The Dynma PR Plus features four workstations. Once assembled, the pressing stage is activated (manual or automatic). The pressing force is applied by hydraulic or pneumatic cylinders with capacity to press even solid wood doors.



Transport & Wrapping Solutions



The BTC conveyor belt has a central beam which can be raised and lowered to allow protective packaging to be positioned on corners of items before the next stage of the packing process. The finished item is positioned centrally along the belt, over the lifting beam. Using a foot pedal the beam is then raised so that protective packaging can be placed on the corners.



The BTG rotary conveyor belt for doors and cabinets, can rotate smoothly and precisely up to 180° thanks to a geared motor with brake. This allows the piece to be turned during assembly operations or to be redirected onto another production line. It can be programmed to turn to a set angle and can be additionally fitted with pneumatic plates to smoothly allow the passage of furniture between transport elements.



The BTP is a flexible assembly conveyor before an automatic assembly press or simply as a manual assembly station. Its solid and strong construction enables pre-assembly work, with an alignment edge in manual or automatic option, which conveniently allows the assembled pieces to be centered on the conveyor belt. It is equipped with a control panel or foot pedal that enables an assembled piece to be moved with just one touch.



The MHR is a lifting platform equipped with gravity rollers when in the lower position for unloading. The platform is automated, for automatic descent working as material stacker or for automatic ascent working as material feeder. The standard dimensions are 2500 x 1000 mm with a maximum load of 2,200 lbs, although other specifications are available.

The PET is a very adaptable hydraulic lifting platform and conveyor belt. The control of the stop levels and usable dimensions can be altered depending on requirements and it can be foot pedal operated or move automatically for integration into a production line.



The MVEB's practical design and straightforward operating controls eases and aids the packing and sealing of cardboard boxes. Equipped with a conveyor belt for loading and unloading, it is particularly suitable for cabinet production lines.



The TLBE is a lifting conveyor belt shuttle used for converging two or more assembly lines which can load or unload at several different heights. It can also be remotely controlled via radio and fed by an overhead electrical system to avoid an additional installation of cables in working areas, with no limit to the maximum range of travel.



The TVB is a hydraulic conveyor belt tilter for use in assembly lines where selected items need to be tilted while on the line. It has an electric driven belt with arms operated independently by a hydraulic unit. It can be selected to work either as a conveyor or as a tilter and is manufactured to the measurements requested by the client.



Transport & Wrapping Solutions



The TVR is a conveyor-tilter with PVC coated gravity rollers, for use in assembly lines where selected items need to be tilted while on the line. The arms are independently driven by a hydraulic unit, it can be selected to work as a conveyor or as a tilter, and is manufactured to the measurements requested by the client.



The VLE is designed to tilt cabinets on to their rear side for packing. The VLE structure consists of a gravity roller conveyor for loading and a motorized conveyor belt for unloading, which is driven by a stabilized pneumatic mechanism.



The VRG is a tilter with gravity rollers, which can be PVC coated or galvanized, which is mainly used at the end of packaging lines. Equipped with a pneumatic stabilizing mechanism, it tilts the item, facilitating its unloading or transfer onto a lateral transport line. The shorter arm can have either a flat platform, a lateral roller or an unloading frontal loader.



The RT2014 enables easy, fast and rational panel returns from the edge bander to the worker. A single worker will save lot of time with a minimum effort to return each processed piece from the outside of the edge bander to the start point.

The BTPI tilting conveyor belt can be used as a door pre-assembly workstation, placed before an automatic press or as an independent workstation for manual assembly. Its sturdy construction allows for comfortable pre-assembly of bulky doors with the possibility to angle the work surface from 0° to 70°. Equipped with a control panel or foot pedal, the door can be released with just the push of a button.



The MA25 cleaning and finishing station provides a straightforward, ergonomic, and incredibly efficient way to maneuver doors for cleaning, quality control and finishing on a production line. During the turning task, pneumatic arms angle the door at 70°, saving operators this repetitive effort. It can also be used to load doors onto the line or unload rejected doors that could not be finished or did not pass quality control.



Featuring an 31"/ 800 mm opening the Atis 125 represents the larger side of the orbital wrapper. Plasticband provides you a technologically advanced, versatile, and safer orbital wrapper. Designed to wrap furniture, doors, panels, wooden boards, cabinets, windows and bulky products. The orbital wrapper features 2 reels with multiple accessories available, such as the Helios automatic bubble wrap, foam, and polyethylene dispenser.



Featuring an 70"/ 1800 mm opening the Atis 250 represents the larger side of the orbital wrapper lines. Plasticband provides you a technologically advanced, versatile, and safer orbital wrapper. Designed to wrap furniture, doors, panels, wooden boards, cabinets, windows and bulky products. The orbital wrapper features 2 reels with multiple accessories available, such as the Helios automatic bubble wrap, foam, and polyethylene dispenser.



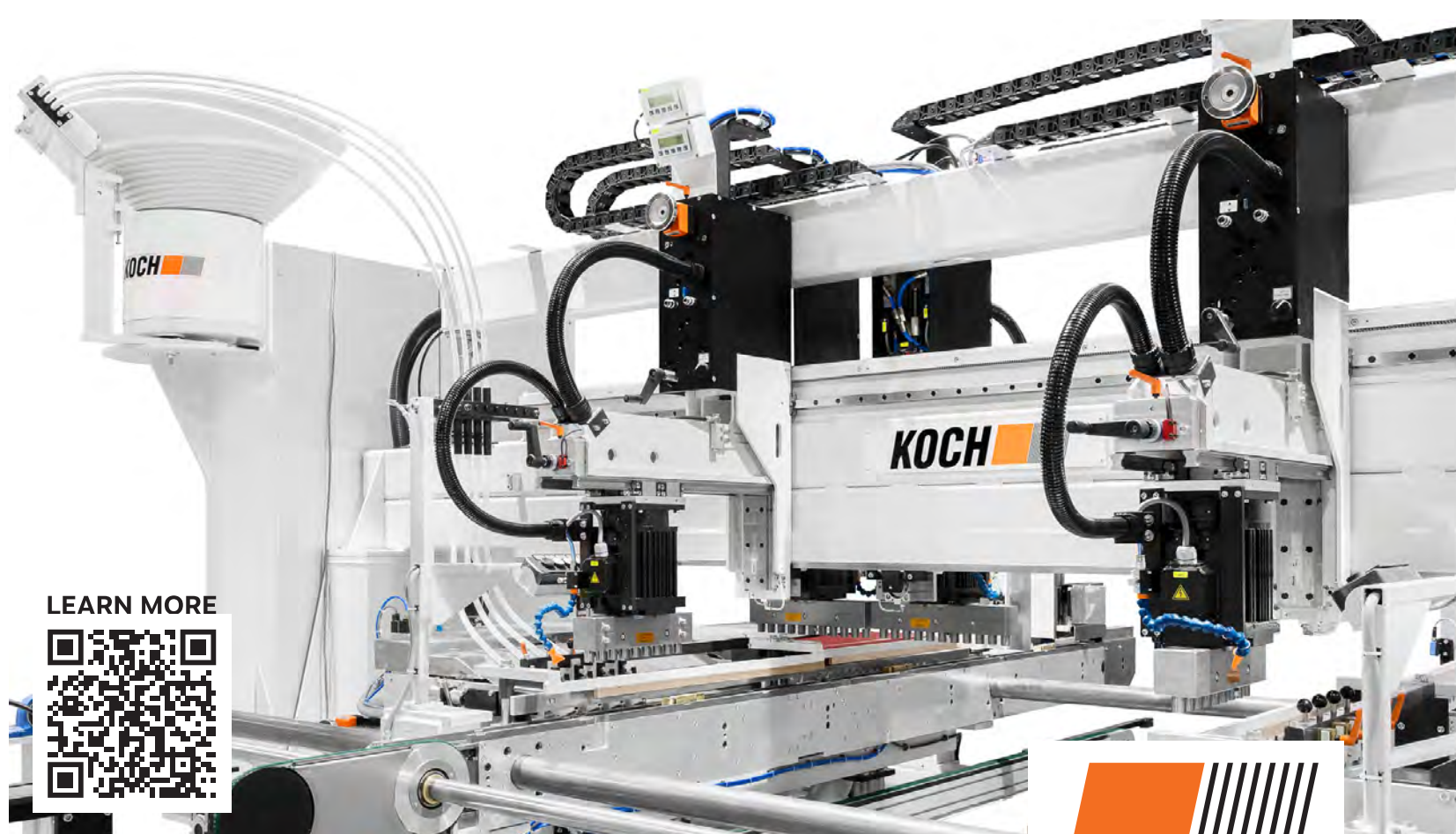

Maximum Flexibility for Drilling and Dowel Insertion

With more than 60 years of experience and a production site located in Germany in the center of East Westphalia's furniture industry, KOCH is a renowned leader in the design and production of high-tech machinery for furniture, door and window manufacturing, as well as other wood products. KOCH is also an authority in the field of joining technology and a specialist in sawing, shaping, drilling, gluing, and dowel insertion.

KOCH LP Machinery + Systems has been importing, distributing, and servicing high-value woodworking machinery throughout North America for more than 30 years. KOCH LP Machinery + Systems supports the North American market with a knowledgeable sales team, factory-trained technicians, and a comprehensive spare parts inventory.

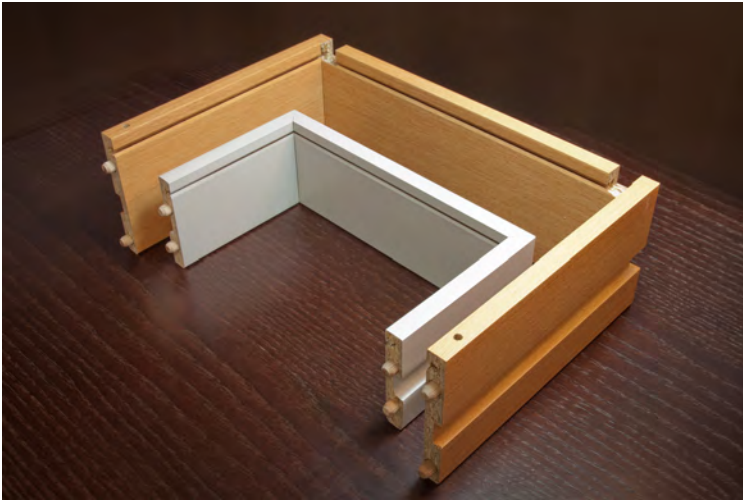

- Drawer fronts
- Drawer side panels
- Drawer back panels
- Folding system drawer

Solutions for Drawers, Doors, and More

KOCH offers concepts to produce drawer parts and folding system drawers. The range of solutions includes machines for just-in-time production, to through-feed machines for larger batch production. Machines can process a variety of materials, and machines provide users with production lines perfectly tuned to suit their needs, and with optional equipment enhancements, they can be tailored to optimize production.

V-GROOVING SAWING UNIT FOR MITERED DRAWERS



INTUITIVE LED LIGHTING FOR QUICK SET UP & SAFETY

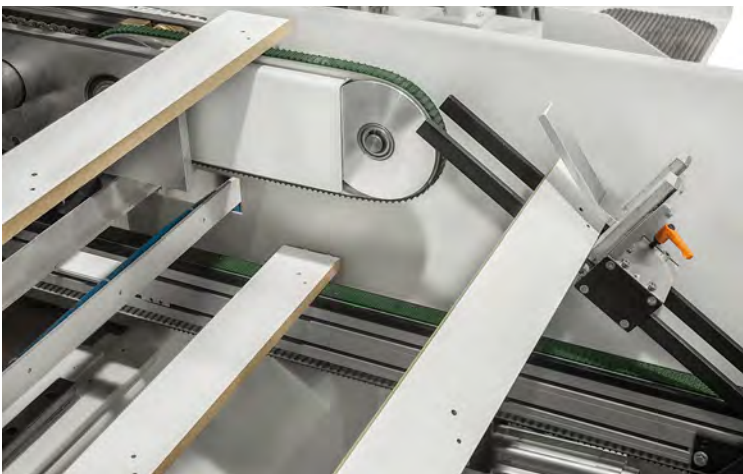

RETURN FEED SYSTEMS FOR HIGH CAPACITY



NOTCHING FOR DRAWER SLIDES & HARDWARE

Drilling & Dowel Insertion



KOCH SPRINT base.line is equipped for horizontal drilling and doweling. However, to achieve maximum processing flexibility, it can be additionally equipped with a vertical drilling station for drilling in the border area. The proven technology guarantees high-quality drilling and doweling results - consistently over long periods- and reproducible accuracy.



SPRINT PEANUT select.line inserts a self-clamping, single component, invisible connector known as the PEANUT. Due to its dome shape, the PEANUT head smoothly slides along the slot created by the T-shaped PEANUT cutter. In assembly, the PEANUT head rides over the lip of the PEANUT slot and slides to the end, this action creates a strong clamping force, pulling the two panels together from the inside. Ideal for RTA furniture and closets.



In our select.line series, various working units can be configured in a variety of ways, providing the greatest number of possibilities to match SPRINT equipment to your individual needs. Whether used for inserting fittings, horizontal or vertical routing, grooving or processing at 45° or 90°, this customized processing center can be perfectly fine-tuned to suit any production process.



The single-sided drilling and dowel driving machine WINDOOR select.line is equipped for all drill processing into the stock ends and edges of window and door components like rails and stiles, crossbar elements, and mounting holes. The machines of our WINDOOR select.line series provide a basis for a wide range of customer specific production concepts. They can be adapted to your individual needs for the window and door production.

Drilling & Dowel Insertion

Fast and high-precision glue application systems that allow intermittent application in various speed ranges. Speed with every operation and easy to use. ON-OFF (cut-off) of the glue flow and the glue dosage are precise and instantaneous, always exact, and constant. Glue gun with 4 different useful settings, with a compact design. Always the same amount of glue and accurate application.



The EasySHOT is a stationary dowel inserting machine with an operating gun for simultaneous operation of glue application and dowel insertion. This manual dowel inserting machine operates, through a sequence of automations, simultaneous operation of glue application and dowel insertion in pre-drilled panels, furniture components, small parts, solid wood components and wood construction components.



The UNIFLEX series combines the flexibility of point-to-point processing with the efficiency of fast series production. Precision, quick set-up and a high level of automation, ideal for panels and narrow parts subject to frequent product changes. These compact, robust machines for double-sided drilling and dowel insertion are perfectly designed to serve either as stand-alone solutions or to fit seamlessly into production lines.



The SBD-45 select.line for mitered door production provides double-sided sawing, drilling and dowel insertion for 45° processing. Equipped with waste conveyor belts, return feed, and the option to swivel from 45° to 90°. It can be equipped with long edge drilling and vertical drilling from either above or below.

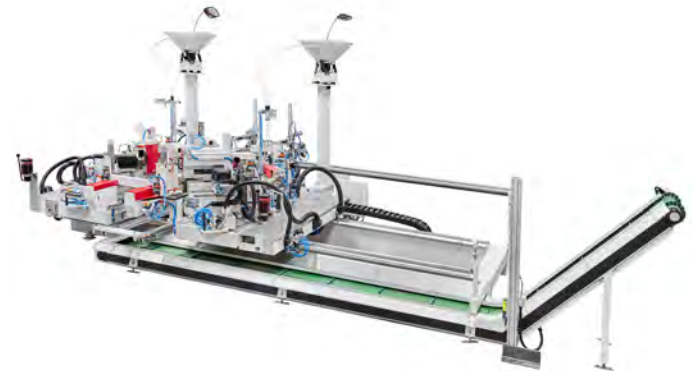



**5-Piece-Door Production
Just-In-Time Manufacturing
Single-Sided Machines with Manual Feed**



The ENDMASTER-K base.line for door RAILS. This machine processes the rails of cabinet doors by applying an edge-banded cap to the wrapped and profiled door part. It precisely trims the edge banding and edge drills female dowel holes to match parts from the complimentary STILE machine below.



The ENDMASTER-P base.line for door STILES. This machine chamfers the edge of stiles, then applies thermo-foil using a hot-stamping roller, finally the part is drilled, glued, and doweled. The stile workpiece of the cabinet door has a finished look and is ready for assembly with the matching RAIL parts form complimentary machine above.



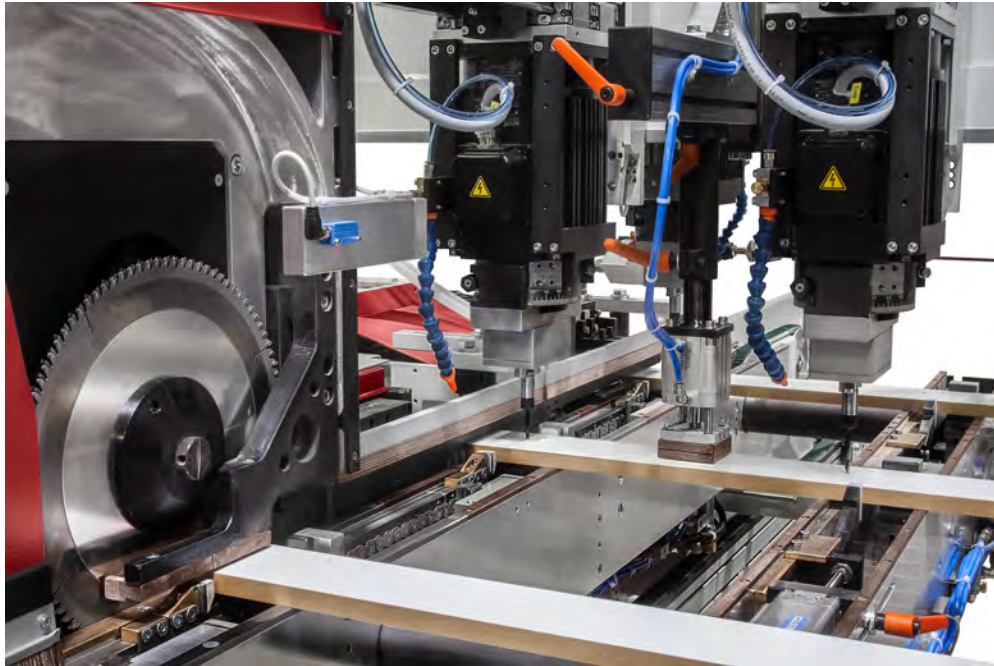

High-performance double-sided through feed machines with automation, precision and robust, safe operation over long periods of time. BD/SBD/SBFD machines are ideal for the processing of:

- Face frames
- Drawer components
- Cabinet components
- Profiled rails/stiles
- Furniture components
- Entrance door



SBD Series - Sawing, drilling and dowel insertion machine for through-feed processing.

- Pocket hole routing
- Screw insertion
- Dowel insertion station
- Horizontal drilling
- Return feed conveyor for one-man operation
- Can process up to 25 pcs/min
- Drilling units from above
- Optional vertical boring and edge-drilling



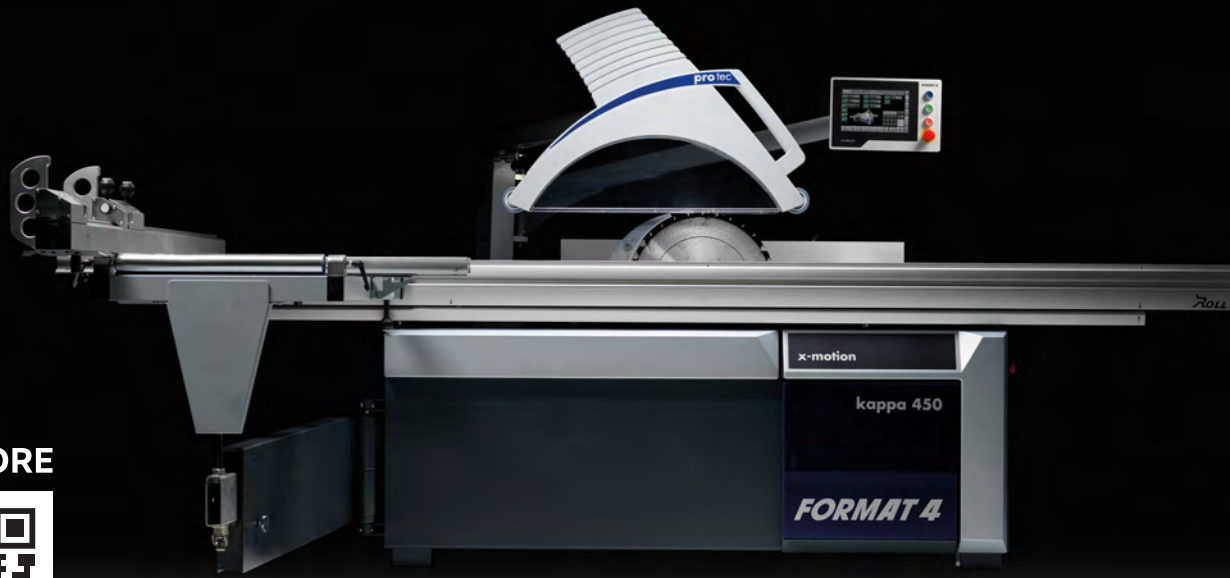

LEARN MORE



Felder Group Quality Means Success for You in Woodworking

With customized solutions, Felder Group raises your production to new dimensions. No matter whether you're in furniture making, in solid wood processing, in window construction or in plastics processing. Faster, with greater precision, more powerful and higher yields - with Format4® woodworking machines you will set new standards! You too can benefit from our know-how.

With the Felder Group service network you can be sure of individual all-round service from the very first minute. Excellent advice, immediate help and on-site service, continuous availability of machines, less down-time, optimal value retention and low subsequent costs - our service for your profit.

Explore woodworking perfection with Felder's Format4® line, available at Coffey Machinery. Crafted with precision and innovation, the Format4® series offers top-tier woodworking equipment to elevate your craft. From the precision and safety of their Sliding Table Saws to the excellent planing capabilities of their Jointers/Planers, and the versatile options with their Shapers, each product is meticulously designed with efficiency and quality in mind.

Format4® Products

Sliding Table Saws

Jointers/Planers

Shapers

Wide Belt Sanders

Heated Veneer Presses

And More

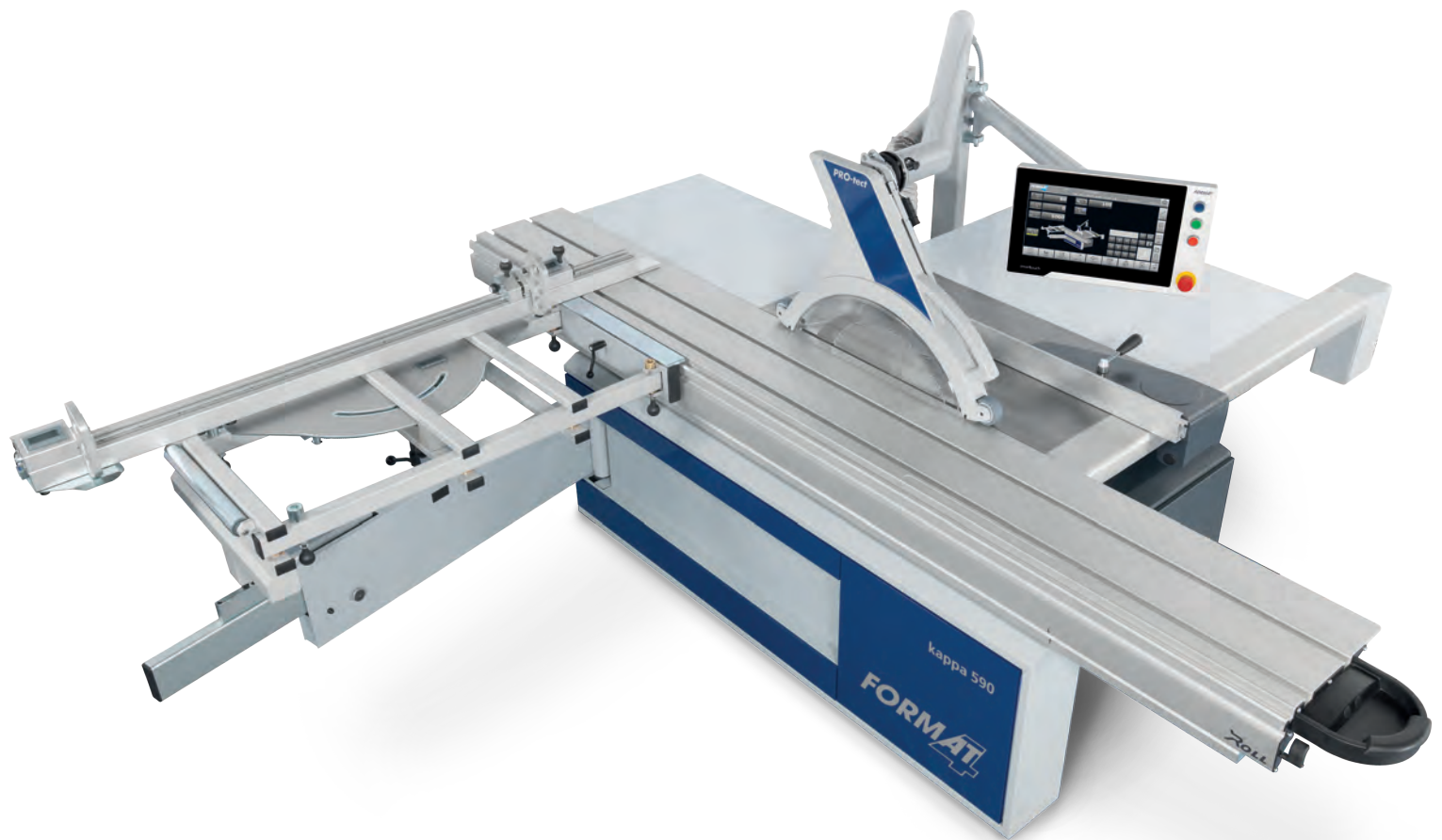

PCS: The Award-Winning Safety System

Woodworking professionals are in safe hands with PCS – the safety revolution for sliding table saws. Serious accidents with sliding table panel saws are a thing of the past – PCS is currently the fastest, non-contact triggering safety device in the world.

The Preventive Contact System recognizes human tissue in the danger zone and triggers before contact with the saw blade. Sliding table panel saws with the PCS safety retraction is ready for use again at the touch of a button and require no additional maintenance or cleaning cycles.



Release triggered within milliseconds without contact

PCS monitors the danger zone 1000 times per second, other systems only manage up to 60 times per second.



No additional maintenance and cleaning cycles required

Other systems have to be checked manually, sometimes every hour!



Immediately ready for use at the push of a button

Other systems require partly expensive spare parts after each release.



PCS works even if contaminated by dust

Other, partly optical systems, hazardous situations can no longer be detected and prevented 100% due to contamination.



Sliding Table Saws

The Format4 kappa 400 x-motion is outstanding in all areas. In addition to a good price-performance ratio, the sliding table saw impresses with its 3-axis control, heavy-duty circular saw unit, sliding table, ease of use, precision, and 80³/₄"–145³/₄" cutting length. The x-motion includes a CNC power unit control with a 5.7" LCD screen on an overhead control panel. Get consistent high performance in industrial continuous operation with kappa 400 x-motion.



Format4 kappa 450 x-motion: A large circular saw unit that enables large blade diameters and a cutting height of up to 6". The x-motion features of the Format 4 kappa 450 impress with an automatic rip fence, unlimited tool storage and programmable cutting sequences in the in-house software. All axes of the machine can be controlled ergonomically and intuitively by the central operating unit with its 10" touch screen. Optional PCS® safety system.



Format4 kappa 550 x-motion: Powerful. Smart. Safe. Design, precision, automation and safety put in a nutshell in the smartest of ways. With a cutting length 86¹/₂"–145³/₄", cutting width of 39¹/₄"–63" and cutting height of 8", kappa 550 ensures maximum efficiency and a noticeable increase in productivity. It's "X-Roll" sliding table includes a generous 10 year guarantee. Optional PCS® safety system.



Format 4 kappa 590: The ingenious panel saw with double pivoting for angle cuts in all positions. The new twin-pivot unit has a total swivel range of 92° and achieves a cutting height of 202 mm for saw blades with a diameter of 550 mm. The highly efficient synchronous motor with continuously adjustable speed control from 2,000 to 5,000 rpm guarantees constant high performance.



Jointers/Planers by Felder Group's Format4® Line

Regardless of whether it is a planer, thicknesser or planer/thicknesser combination, the premium brand Format-4 guarantees perfection with its innovative high-tech solutions such as the Silent Power spiral cutterblock. Generally, the main criteria for buying a planer is the intended area of use, a defined amount of space, ease of use and sustainability in terms of the cost of planer knives. A quick commercial answer is the intended area of use, planing, thicknessing or both in one, with a defined amount of use per day, per month or per year. The higher the expected workload, the higher the quality and stability required of a new planer/thicknesser.



Jointers/Planers

The plan 51L planer from the premium brand Format4 impresses with its new design and above all with the new three metre planing table length. The feeding planer table alone offers 1,650 mm of adequate supporting surface for larger dimensioned workpieces. As an absolute highlight, the new plan 51L is the first Format4 planer that offers a tiltable planing table for concave and convex joint finishing.



Format4 exact 51: Precision and comfort for heavy use. With options including a segmented infeed roller, rubber coated rollers as well as below table rollers and much more, the new Format4 exact 51 also comes at an incredibly attractive price. With a spring loaded segmented outfeed pressure bar and variable speed adjustment of between 5 and 65.6 ft/min (20 m/min), the new exact 51 can be equipped to the exact specification that the customer requires.



Format 4 exact 63: 24" planing width meets every requirement! Maximum performance, easy operation and individual machine options available at a competitive investment price, guarantee perfect planing results for even the most demanding tasks. The planer with the Format4 System cutterblock, 120 mm knife flight and 4 knives delivers performance, precision and user-friendliness all-in-one.



Format4 dual 51: Perfect precision at just a touch of a button. The jointer table adjustment system, 4 $\frac{3}{4}$ " (120 mm) cutting diameter and patented Format4 system cutterblock guarantees perfect jointing results. An intuitive operating concept reduces the effort in changing from jointing to planing to a minimum, increases the productivity and ensures that the dual 51 is a profitable investment for workshops, businesses and industry.



Format4® Shapers by Felder Group

Format4 Shapers are meticulously designed to meet the most demanding requirements, offering constantly high performance in industrial continuous operation. With their solid design and premium components, these Format4 Shapers will ensure reliability and longevity in your business.

The spindle quick-change system on profil 45 M and profil 45 Z, will provide you with almost limitless possibilities of use. You can use shaper spindles with pre-mounted moulding tools for moulding in series, but also spindles of various diameters. Spindle changes can be done in a few seconds. A particular highlight is the ability to mount a high speed router spindle with 15,000 RPM capability.



Shapers

Format4 profil 45 M: The powerhouse with premium comfort. The new high tech tilting shaper from Format4 offers premium operating comfort and top quality manufacturing precision. The profil 45 M has a table opening of 320 mm. Its quick change system for the shaper spindle comes standard. With elegant design, a long and solid cast iron shaping table and innovative detailed solutions, the profil 45 M deals with all requirements of professional woodworking.



The Format 4 profil 45 Z tilting shaper offers perfection at the push of a button regardless of the operation. The highlights for the professional user: height and angle adjustment of the spindle as well as the positioning of the spindle fence can be quickly and easily adjusted from the control panel. The spindle quick change system ensures extremely quick changeover times and maximum production efficiency.



Format4 profil 92 M e-motion: The sophisticated electro-spindle is equipped with an HSK 63F interface for automatic tool quick-change system with pneumatic clamping. The tilting range of +/- 46 degrees allows unlimited processing possibilities. The rotation speed, spindle height and angle as well as the spindle shaper fence and table opening can be adjusted intuitively and precisely with the e-motion control in the 15" touchscreen control panel.



FORMAT 4®

Computer controlled Format4® tilting spindle moulders with quick spindle exchange system have been a guarantee of absolute excellence in woodworking for many years.

Format4® Wide Belt Sanding Machines

Wide belt sanders from Format4 - the first choice for those who demand a “finish” that is beyond perfect. Explore precision and efficiency with Coffey Machinery's Format4 Wide Belt Sanders from the Felder Group. The findustry line offers customizable units for diverse surface finishes, ensuring industrial-grade performance. The Format4 finebrush 1355/1353 brushing machines are ideal for universal applications, featuring optimized brushing units and user-friendly controls. Additionally, the finish 1352 modular and 1353 modular wide belt sanders provide impressive flexibility with 2 or 3 belt configurations, allowing for optimal adaptation to specific requirements. Elevate your woodworking shop's capabilities with Felder Group's Format4 line.



Wide Belt Sanding Machines

Format4 finebrush 1355 / 1353: The new brushing machines for universal applications. With 5 or 3 brushing units, workpieces with profiling or structure are optimally fine sanded and prepared for the final surface finish. The abrasive brushes are equipped with two grit sizes in combination with the reverse direction of rotation. The fixed infeed table height of 900 mm guarantees simple and effortless work. Working width: 1350 mm. Grinding height: 3–140 mm.



Format4 findustry 1352 | 1353 | 1354 - The new wide belt sanding machines for individual requirements. The machine can be equipped with two, three or four units, precisely adapted to the specific use and the respective field of application. Intuitive touch screen controls allow the the infeed thickness to be set to the tenth of a millimeter directly from the control panel at the touch of a button. Sanding height: 3–170 (200) mm. Sanding width: 1350 mm.



Format4 Wide Belt Sander finish 1353 modular: Wide belt sander with cutterblock planing head. Either as a 2 or 3 belt machine – you can decide the individual equipment and configuration of the processing units. Equipped with a cutterblock planer head with 1,350 mm processing width positioned on the machine infeed side. Sanding height: 3–170 mm. Optional touch screen control is available. Push button can be adjusted with an accuracy of 0.1 of a millimeter.



FORMAT 4®

The wide belt sanding machines from the Felder Group make the entry into professional woodworking simple and the high-quality system solutions are particularly impressive.



LEARN MORE



SawStop is North America's #1 Table Saw

SawStop's focus on practical innovation, combined with their obsession for using the highest grade materials, produces saws unlike any before experienced by woodworkers. Their engineers and builders have every intention of creating the finest table saw, from design and materials to assembly and ultimate functionality.

SawStop offers a versatile line-up of table saws that are ideal for your woodworking needs. While all SawStop saws include our revolutionary, finger-saving technology, each saw offers a unique set of features that will ensure you have the precision and power to meet your needs. SawStop sells three saws with cast-iron tops (in multiple configurations) that work perfectly in a shop setup. And we have two portable saws that work as well in the garage as they do on the job site.

AIM: Active Injury Mitigation

A table saw accident happens once every nine minutes in North America. SawStop's revolutionary safety system reduces what could be a potentially life-changing injury into a scratch by stopping the spinning blade on contact with skin.

SawStop's patented active injury mitigation (AIM) safety technology is what makes a SawStop a SawStop. Owning a SawStop means having best-in-class performance without compromising your safety.

1

Detect

The blade carries a small electrical signal. When skin contacts the blade, the signal changes because the human body is conductive. The change to the signal activates the safety system.

2

Drop

An aluminum brake springs into the path of the blade. The blade comes to a complete stop and power to the motor is shut off.

3

Stop

After the blade comes to a stop, the blade's angular momentum drives it beneath the table, removing the risk of subsequent contact. All of this happens in **less than 5 milliseconds**.

4

Reset

Resetting the saw yourself is easy. Simply inspect the blade (and change if damaged) and replace the brake cartridge, and your saw is operational. The entire process takes 90 seconds and you're back to work.



The SawStop® Industrial Cabinet Saw

The SawStop® Industrial Cabinet Saw is the definition of industrial grade. It is the heaviest, most powerful and highest-quality 10" cabinet saw available. The 3HP, 1ph, 230v configuration with available 36" or 52" Industrial T-Glide Fence Assembly offers the durability, versatility, and the peace of mind only SawStop's patented safety system can provide. The Industrial Cabinet Saw is almost 700 lbs of iron and steel – built for heavy-duty cycles with maximum stability and precision, its larger, heavier tabletop provides an extensive cutting surface.

99% dust collection is delivered above the table with the included dust collection blade guard, and below the table with advanced shrouding around the blade. Available Overarm Dust Collection (Model # TSA-ODC, sold separately) routes dust away from the blade and into the 4" port. Durable craftsmanship and thoughtful details combine for consistent, reliable performance in the most demanding industrial environments.



SawStop® Table Saws

The SawStop® Compact Table Saw is the smallest, most portable saw in the SawStop lineup. Its 10" blade provides maximum cut capacity. The Rack & Pinion fence is easy to adjust and reliably square, with built-in high and low faces that support all kinds of cuts. Quickly and easily tilt the blade to your ideal angle with just one hand. The micro-adjust feature provides the ability to dial in a precise cutting angle. Stow away tools for easy access and quick retrieval.



The SawStop® Jobsite Saw Pro delivers durability, innovation and precision with a design that's built for the worksite. Its 24 5/8" table depth allows a larger surface to make safe and accurate cuts from. Included Active Dust Collection Guard for class-leading dust management. One-turn elevation allows the user to raise and lower the blade in a single turn, and the Quick-Tilt adjustment tilts the blade easily and quickly to the ideal angle in 1-degree increments.



The SawStop® Contractor Saw offers versatility, reliability, and safety for a variety of users. Available in a 30" standard fence assembly, 36", or 52" T-Glide fence assembly. With over 150 unique configurations, the Contractor Saw is the most configurable SawStop saw. Two steel extension wings are included. Adding a mobile base, sliding crosscut table or router table, are just a few of the ways to make this your ideal saw.



The Professional Cabinet Saw is SawStop's top selling cabinet saw, offering unmatched fit and finish and best-in-class cutting performance. Its available 30" premium fence assembly, 36", or 52" T-Glide fence assembly provides smooth operation, precision measurement and sure lockdown without deflection. The trunnion and arbor are built for precision, strength and stability. The gas piston elevation delivers smooth and easy adjustability.





EASY Lock Miter, EASY Coping, EASY Drawer Notching

Circle T Manufacturing is an American woodworking machinery manufacturer located in Central Illinois. Circle T Manufacturing specializes in providing unique, world-class machines to our customers in the high-end cabinetry and architectural millwork industries. Their EASY Lock Miter LM116 has revolutionized the way joinery is done for cabinet makers and millwork companies; their EASY Coping Machines C117 and C220 have also changed the game for end-coping cabinet doors with our EASY Quick-Change Spindles; and lastly, their EASY Drawer Notcher M312 is a staple in the under-mount glide world of woodworking.

Circle T is dedicated to serving their customers through excellent craftsmanship, quality control, and rapid response to service needs. Each member of Circle T works diligently to ensure that their customers are continually delighted with their products and services.

EASY Lock Miter LM116: Uniquely designed to produce an extremely precise and easy lock miter joint. A and B profiles are cut using a single pneumatic powered tilting spindle! With EASY Lock Miter LM116, there's no downtime setting up and changing out your shaper, and no more running pieces on their side. Many customers use the EASY Lock Miter LM116 for face-frame cabinetry, beams, pillar/column wrapping, box newel posts, solid surface, and more!



EASY Coping Machine Model C117: With user-friendly controls, setup, and a quick-change head, the C117 makes coping easy. Its foot pedal cycle start adds to the operational ease. The pneumatic hold-down clamp system ensures secure and stable material placement. Use your current heads on this machine with our quick-change spindle—no tool holders needed. Y and Z axis adjustments with digital readouts give you complete control over your work.



EASY Coping Machine Model C220: Elevate your coping experience with all the outstanding features of the C117, now enhanced with the added benefit of two easy quick-change spindles. The C220 offers a smooth workflow without any vibration or tear out. Its foot pedal cycle start allows for uninterrupted operations. The pneumatic hold-down clamp system ensures secure material placement. Y and Z axis adjustments, complemented by digital readouts.



Easy Drawer Notcher – M312: Notch and drill simultaneously with an easy foot pedal cycle start. Includes center fence drawer box alignment. With its high wear-resistant phenolic top, the M312 is durable and fast – just 10 seconds per box! Drawer clamps ensure your drawer box does not move during a cycle. Its switches ensure the machine cannot cycle without a drawer present. Retraction of the cutter and drill between cycles.



Specialized Machinery For Pressing, Boring, and More

ITALPRESSE

Italpresse is the global leader in pressing technologies. Founded in 1952, Italpresse has manufactured over 30,000 presses and press systems with a customer base in over 130 countries.

SEVERAL SAMPLES OF CONCEIVABLE PRESSES FROM ITALPRESSE



The model XL offers a single or multi-daylight format Hot Press. This affords companies with the flexibility to maximize their output with minimal floor space. Designed for the use of laminating such materials as veneer, HPL, acrylic, and decorative overlays to cores such as plywood, and MDF. They are also the standard go to machines for the manufacturing of foam injected panels for the HVAC, insulated panels, and foam insulated door markets as well.



The Magnum multi-daylight pressing line(s) provides for the simultaneous loading into the press of multiple doors by means of a multi-level automatic loader. Different sizes, specific pressure and number of daylight are available, depending on the production needs and requirements. The Magnum model can be configured as an individual multi-daylight press or as two independent superimposed multi-daylight presses, served by a single loader.

LEARN MORE



Technologies and solutions for woodworking.

The MATRIX with automatic pin pedestal system is the pinnacle of Italtresse's range of air membrane presses. It is designed and engineered for the highest requirements in productivity, flexibility, and reliability. Complete with automatic unloading systems with either a 180° vacuum device or a 180° barrel turnover to create the highest volume of product possible. Available in 8', 10', or 12' tray lengths with 3 and 4 tray models also available.



The PV/PHF Hydraulic press system for bending and stabilizing a variety of materials including solid wood, plywood, thin MDF, and composite materials. Production of chair components, bed components, curved doors, and commercial and residential fixture and furniture parts. Supplied with Radio Frequency generator(s) to accelerate the stabilization and glue curing processes.



The Mark/C pairs lean manufacturing with zero setup and total flexibility to adapt automatically to batch one production. Employing a unique combination of a load scanning system and an axis control system for the cylinder stroke that allows complete random loading of the press from load to load without any input from the operator. One load could be a large conference table top and the next a single drawer front.





CNC Woodworking and Timber Processing Centers

Essetre is the solution for furniture and timber engineering of today and the future. Essetre produces special and customized woodworking centers with patented technologies. In this way, you can have at your disposal a high precision and extremely long-lasting machine, able to speed up operation, and increase your productivity.

Your next Essetre machine will be unique, since it is engineered and built strictly according to your requests.

— Essetre is the solution for furniture and timber engineering of today and the future.

SEE JUST A FEW OF ESSETRE'S INCREDIBLE MACHINES BELOW

The Techno Fast is the quickest, most versatile, and compact working center on the international market. The processing takes place automatically thanks to a motorized loading system, which transports the beam on the loading roller conveyor integrated in the machine structure.



The Techno Saw is a compact, flexible and intuitive working center suitable for small sections. The Techno Saw is designed to cut and process trusses, elements of frame houses, and light and solid wood beams. The Techno Saw has a patented milling head with 5 continuous interpolating axis for the processing of the 6 faces of the workpiece.



The Techno PF 1250 EVO is a revolutionary working center that has been meticulously designed for the construction of wooden structures, roofs, beams, and X-LAM / CLT walls with a width up to 1300 mm. The working area inside the cabin consists of 2 independent opposing operating units, with 5-axis milling heads in continuous interpolation and 12 kW electrospindles at 7,000 RPM.





LEARN MORE



A Leading Manufacturer of High-Quality Machines

Bacci has recently developed a complete line of 5-axis and multi-axis CNC machining centers, all equipped with the highest technology and operating softwares. This new line of machines has a wide range of applications, spanning from chair manufacturing to tables, doors, windows, and furniture components in general, right to the manufacturing of elements in plastic, aluminum, and composite materials.

The wide range of Bacci machining centers, coupled with the company's competence in customizing and studying specific applications, puts us in the position to satisfy the needs of any and all users. Bacci has been manufacturing top-quality machines for over 100 years!

Bacci BMT.4AXIS is a compact CNC machining center for miter, mortise and tenon of solid wood and MDF wrapped material. The Bacci BMT.4AXIS is the only machine to be equipped with a 4th NC controlled axis that allows complete elimination of any possible manual settings, other than for a tool change. This machine is the ultimate flexible solution for joint processing. The Bacci BMT.4AXIS is an extremely capable CNC machining center for door components.



The new T4MO CNC unleashes the creativity of designers, easily reproducing wood elements based on their 3-dimensional drawing. The four spindles, controlled in pairs, automatically reproduce – in one machining cycle – four identical parts or two couples of perfectly mirrored components. T4MO CNC offers superb finishing quality at the highest output, with a faster setup time and a higher speed on cycle time, compared with conventional copying lathes.



EVOLUTION.JET is a highly flexible machining center both in terms of sizes customization and in terms of the number of working tables that can be fitted with equipment for manual, semi-automatic, or fully automatic loading and unloading. Ideal for simultaneously machining all the various components required to assemble chairs or furniture on a single machine.



MASTER.PRO 3+3+1 RAIL is the ideal machine for the shaping and sanding of cabinet doors and drawers. MASTER.PRO is a double 3-axis machining center with 3 independent rails and pods tables. The two 3-axis operating heads can work independently on separate tables, increasing the machine output. The machine is equipped with a touch screen software interface and a bar code reading system (one for each table) for immediate table set-up.



Dust Collection and Waste Management

From small point of collection to large whole plant solutions, Coffey Machinery can help your business meet any of its dust collection and waste management needs.

CECO KB Duct

CECO KB Duct is a leader in standard, modular ducting systems (clamp-together and flanged), individual components and application-specific duct solutions for industrial dust, fume, mist, and air handling systems. KB Duct began as a part of CECO Kirk & Blum brand, which has been in operation since 1907.





LEARN MORE

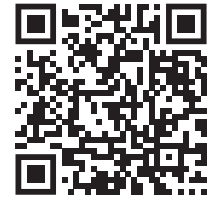

WEIMA's wood waste shredders are ideal for reducing bulky scrap into a more manageable commodity.

WEIMA offers a comprehensive range of industrial shredders. The global popularity of this shredder series assures high reliability at a competitive price to performance ratio. These machines set themselves apart from other machines of their size and type due to their robust construction, giving them a longer life cycle.



WEIMA offers a comprehensive range of briquetting presses. Choose from compact entry-level machines for small to medium throughputs, robust all-rounders with proven clamp technology for medium throughputs, to industrial multi-shift machines for the highest briquette quality and throughput demand.



The horizontal single-shaft shredder series includes the Beaver and Tiger machines. These wood shredders are perfect for the shredding of linear wood waste. This shredder is great for turning solid wood waste into chips. The shredded material is placed into a vibratory infeed conveyor that is the same width as the machine itself. This conveyor feeds the material consistently into the shredder.





LEARN MORE



The Nederman S-Series dust collector is an enclosure-less, silent, and simple to set up dust collector for your wood dust collection needs. The S-Series is compliant with NFPA combustible dust regulations. It is equipped with the Super Bag filter which is safe for use with wood dust and is 99% efficient.



The Nederman FlexPAK DX is a frequency controlled high vacuum dust collector for extraction of combustible dust. FlexPAK DX is suitable for cleaning the workplace, the shop floor and machines. It is also very suitable for on-tool applications. FlexPAK DX regulates the speed of the motor automatically depending on the vacuum demand.



The Nederman FlexFilter EX is a state-of-the-art filter system to meet your current and future needs. The Flexfilter EX is manufactured to withstand overpressure from a potential explosion and is equipped with an explosion relief panel. The dust collector is fully earth bonded in all modular components. All electric equipment is EX classified for combustible dust.



The NFKZ3000 baghouse dust collector with chain conveyor is suitable for handling large volumes of air with heavy material contamination levels. It is a modular filter made of galvanized steel sheet. Filter has telescopic support and is suitable for outdoor use. Each module, 2400 mm (94") of the filter design is fitted with a combined inspection and explosion relief door. Filter cleaning with regeneration fans.

LEARN MORE

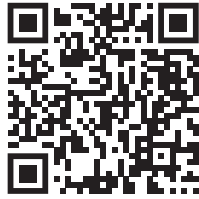

ENTECCO^{USA}

filter technology



The Entecco Schlingmeister 3000 is an exterior, modular, expandable central dust collector for woodworking with up to 13,000 CFM per module. Each module has one or two 25 hp fans located inside the clean air plenum. Each fan moves 6,500 CFM.

- Fans located inside the clean air plenum reduce the amount of duct and associated static pressure.
- Less duct means lower energy consumption.
- Noise pollution is greatly reduced.
- The fans do not have a “footprint” on the ground.
- Complete control panel with motor starters, sensors, data logging, inputs, and outputs.
- One or two fans are equipped with a Variable Frequency Drive (VFD) to speed or slow the fan to maintain sufficient airflow for the number of machines in operation. This design reduces energy consumption compared to a single large fan.
- Continuous production with redundant fans.
- Explosion vents are directed upward for personnel safety.
- 81 bags per module in a 9 x 9 array (1,884 SF of media).
- 3 vibratory cleaning devices in each module operate when the fan is off.
- Rotary airlock, sprinklers, access ladder, and service platform included.
- Additional modules can be equipped with drag chain (for solid wood) or screw conveyor (for panel processing).
- NFPA-compliant
- Expandable - largest installation has 17 modules.



Dust extractors from the SPÄNEX SMU series are used to extract dust from one or more processing machines. The extraction volume flows range from 1,200 to 10,000 m³/h and are therefore the primary solution for joinery and carpentry workshops.

COMPACT • POWERFUL • QUIET



SPÄNEX SMU 60: 3,500 CFM

SPÄNEX SMU 85: 5,000 CFM

LEARN MORE



Equipment Variants

- Automatic start of the fan
- Automatic control of lock slides
- Operation via frequency converter
- Level monitoring in the containers with charging of briquette press or container and/or silo
- With briquetting press or externally installed container
- Ignition protection system

PLUS POINTS

- Small footprint
- Low overall height
- High suction power
- Low power consumption
- Quiet operation
- Ease of operation
- Several disposal options
- Effective filter and cleaning technology
- No heat loss due to direct air recirculation
- Complete control system with automatic start-up
- Tested safety (GS and H3 test marks)



Dust Extractor with Briquetting Press

FM Each
Up To 4 Units In Tandem

applications, briquetting is a
good alternative solution because
of its specific advantages:

- reduction of up to 90%
weight of residual materials
- production of sellable briquettes
- reduction of the risk of fire and
pollution due to fine dust



“

The best thing about Coffey Machinery is that they really are an extension of our business and act as a consultant. If we can we do something more efficiently, faster, or with better quality, one of our first calls is to Coffey Machinery.

Jeff Hunt

General Manager • Chief Operating Officer
Heister House Millworks

WATCH VIDEO





Sales Service Installation Training

CONTACT FORM



Schedule A Factory Tour

Visit us in our working factory showroom at Coffey Machinery's headquarters in Amsterdam, New York. Get a hands-on experience with a diverse range of cutting-edge products, and witness firsthand the craftsmanship that sets our brands apart.

Contact Coffey Machinery For Sales & Training Solutions

Our knowledge of process improvement and lean strategies makes us the experts no matter the size of shop or problem. **Schedule a meeting with one of our team members today.**

5 Shuler Street, Amsterdam, New York
(518) 897-3000 | sales@coffeymachinery.com
www.coffeymachinery.com





NOTES